



Installation Manual

FXD Power Down on Demand

Fold-A-Vador[®]

Rail Gate

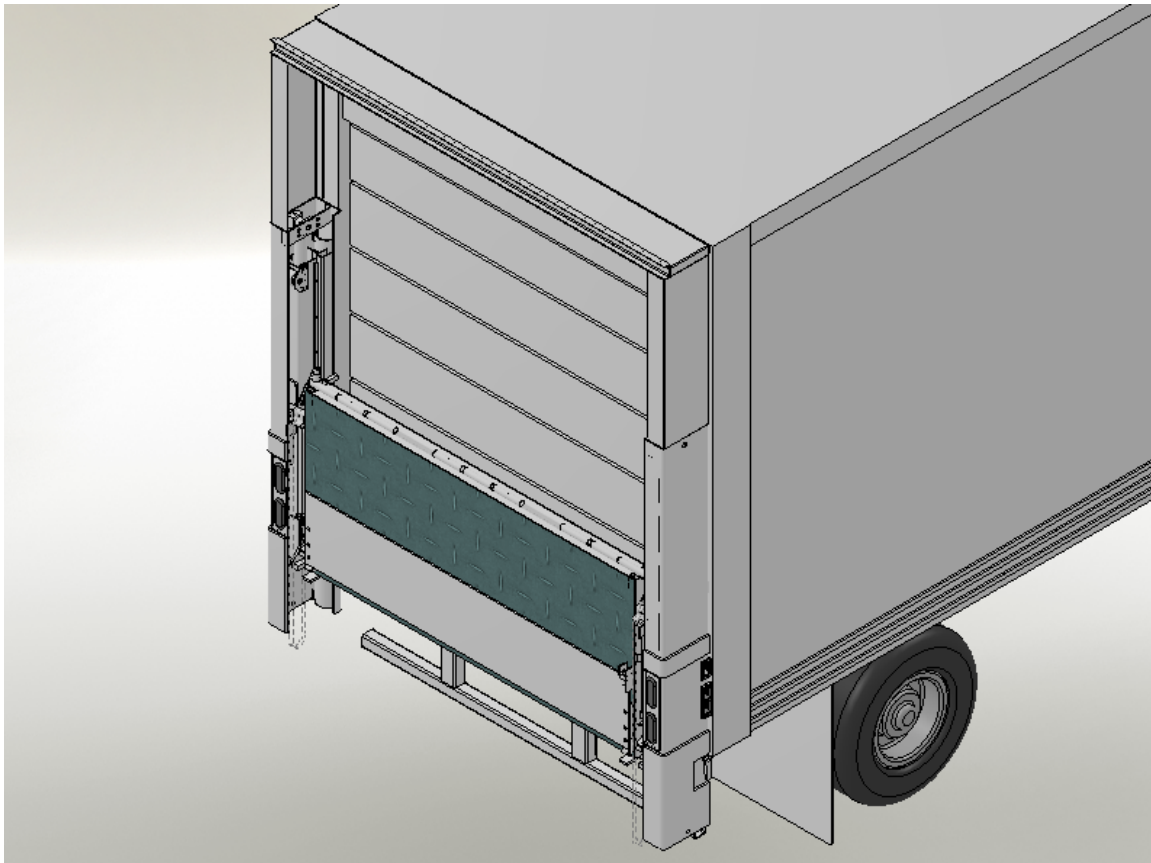

10335 Wayne Avenue • Cincinnati, OH 45215
Ph: 513.891.6210 • Toll-Free: 866.539.6261
Fax: 513.891.4901
www.leymanlift.com • sales@leymanlift.com

LML00422-06/5/24

TABLE OF CONTENTS

| | |
|--|---------|
| Introduction | 2 |
| Words of Caution | 3 |
| Preparation of the Vehicle | 4 - 8 |
| Reinforcement for “Break-away” Bodies and Flat Bed Installation | 9 |
| Unpacking the FXD® | 10 - 11 |
| Optional Bolt-on Kit for FXD® | 12 |
| Hoisting the FXD® into Position | 13 |
| Welding FXD® to Vehicle | 14 |
| Remove Floor Locator Tubes and Shipping Tube | 15 |
| Installing the Header Enclosure | 16 - 18 |
| Mounting Power Unit Frame | 19 |
| Grounding Recommendations for Tractor/Trailer | 20 |
| Charge Line – Battery Hook Up | 21 – 22 |
| Recommended Hydraulic Oil – Lift Gate Specification | 23 |
| Connecting Switch Wiring to Power Unit | 24 |
| Dual Power Unit Electrical Connections | 25 |
| Hydraulic Lines | 26 – 27 |
| Bleeding the Lift Cylinders / Bleeding Power Fold Cylinder | 28 – 29 |
| Connecting Stop / Tail / Turn Lights | 30 |
| Painting the Vehicle | 31 |
| Installation of Warning Signs / Decals & Model / Serial No. Tags | 32 – 35 |
| Final Installation Inspection | 36 |
| Operating the Lift Gate | 37 |
| Electrical / Hydraulic Diagrams & Walk Around Electrics | 38 – 40 |
| Maintenance Minder 2® Controller Menus and Notes | 41 – 44 |

INTRODUCTION

This manual contains the operating procedures on the equipment your company is using that was manufactured by Leyman Manufacturing Corporation.

Past experience has indicated that it is most unwise to operate these units without proper instruction, which should be instituted by the purchaser.

While these products have certain safety features engineered into their design, they are all operated by human beings. Therein lies the problem of safety and one should always have caution in mind when operating this or any other machine that has parts that weigh several hundred pounds.

Again, let us remind you that there are moving parts on this product that weigh several hundred pounds. These parts, when not under proper control, can cause physical damage to the operator. Because of the weights that are involved, carelessness and neglect of training can make these units dangerous.

Do not overload this product. Maintain it properly. Stand clear of moving parts. Operate as instructed.

This lift gate has a long life expectancy and will take some abuse. Use good judgment when operating this equipment.

PLEASE FILL IN FOR YOUR RECORDS

| | |
|-----------------------------|---|
| CUSTOMER: | _____ |
| MODEL: | _____ |
| CAPACITY: | _____ |
| TYPE: | _____ |
| POWER: | 12 VOLT _____ |
| PLATFORM: | _____ |
| SERIAL: | _____ |
| OPTIONS | _____ |
| | _____ |
| | _____ |
| | _____ |
| MAXIMUM HEIGHT: | 56" |
| HYDRAULIC PRESSURE: | AT BY-PASS 2,500 PSI AT THE PUMP |
| AMP DRAW: | AT BY-PASS 235, UNLOADED 130 |
| POWER DOWN ON DEMAND | |

**WHEN PLACING A PARTS ORDER, PLEASE PROVIDE
THE SERIAL# AND MODEL# OF THE GATE.**

WORDS OF CAUTION

1. BEFORE ANY MAINTENANCE IS PERFORMED ON THIS UNIT, READ AND UNDERSTAND THIS MANUAL COMPLETELY.
2. DO NOT STAND ON OR BEHIND THE PLATFORM WHEN OPERATING GATE IN THE FOLDED POSITION.
3. DO NOT STAND IN FRONT OF THE PLATFORM WHEN LOWERING FROM THE VERTICAL POSITION OR OPERATING IN ANY MANNER.
4. MAKE SURE THE GROUND IS CLEAR UNDER THE PLATFORM WHEN LOWERING.
5. CHECK THE AREA AROUND THE UNIT FOR ANY PERSONS BEFORE OPERATING THE LIFT GATE.
6. NEVER EXCEED THE RATED LOAD CAPACITY OF THIS GATE. DO NOT OVERLOAD - MAXIMUM RATED CAPACITY IS BASED ON AN EVENLY DISTRIBUTED LOAD OVER THE PLATFORM FLAT SURFACE.
7. ALWAYS LOAD AS CLOSE TO THE CENTER OF THE PLATFORM AND AS CLOSE TO THE CENTER OF THE TRUCK SILL AS POSSIBLE.
8. DO NOT ALLOW PERSONS TO OPERATE THE UNIT UNLESS THEY HAVE BEEN PROPERLY TRAINED TO DO SO.
9. USE ONLY FACTORY AUTHORIZED PARTS FOR REPLACEMENT.

THIS MANUAL REFLECTS MOST CHANGES AND UPDATES OF MATERIALS THAT ARE COMMON TO THIS TYPE OF LIFT GATE. SOME MAY DIFFER DUE TO INDIVIDUAL CUSTOMER REQUIREMENTS. THIS MANUAL HAS BEEN ESTABLISHED TO REFLECT THE COMMON ITEMS.

WARNING: THIS GATE HAS POLYMER GREASELESS BEARINGS IN THE PLATFORM PIVOTS, AND CYLINDER. WHEN WELDING BE SURE TO GROUND DIRECTLY TO THE COMPONENT BEING WELDED.

PREPARATION OF THE VEHICLE

Read the Installation manual completely before proceeding with the installation of the FXD®.

Do not remove any packing, banding or shipping straps until instructed to do so in the manual.

The FXD® must be installed as described in this manual. Any deviation from the installation method described herein without written permission from Leyman Manufacturing Corporation will void any warranty issued with this unit.

NOTE:

Special preparation must be completed before installing the FXD® on vehicles with aluminum rear corner posts. Contact Leyman Manufacturing Corporation before proceeding with any installation involving aluminum rear corner posts.

NOTE:

The use of a battery charger as the sole power source to operate the lift gate is unauthorized and will prevent the lift gate from working properly. The FXD® must always be operated in conjunction with at least one (1) 12-volt heavy-duty dual purpose or AGM battery on a trailer application, although we recommend using two (2) batteries. A minimum of 9.5 volts must be maintained in order for the valves to operate.

If installing on a truck, you must disconnect the ground from the battery. If this is ignored, the motor controls and charging system can be damaged.

Also, verify that the Maintenance Minder 2® Controller has been unplugged before welding the gate to the vehicle, in order to prevent damage to the MM2 Controller.

PREPARATION REQUIRED TO THE REAR OF THE VEHICLE BEFORE MOUNTING GATE TO VEHICLE

There are many different types of trucks and trailers. Some will have to be modified for proper FXD® installation. The rear corner posts must be flat and flush with the rear sill. An example is shown below, and over the next few pages, to assist you in preparing the vehicle for lift gate installation.

The shaded area is the surface the FXD® mounts to. This area must be all in one plane and square to the ground. This can be accomplished by removing metal or adding fillers.

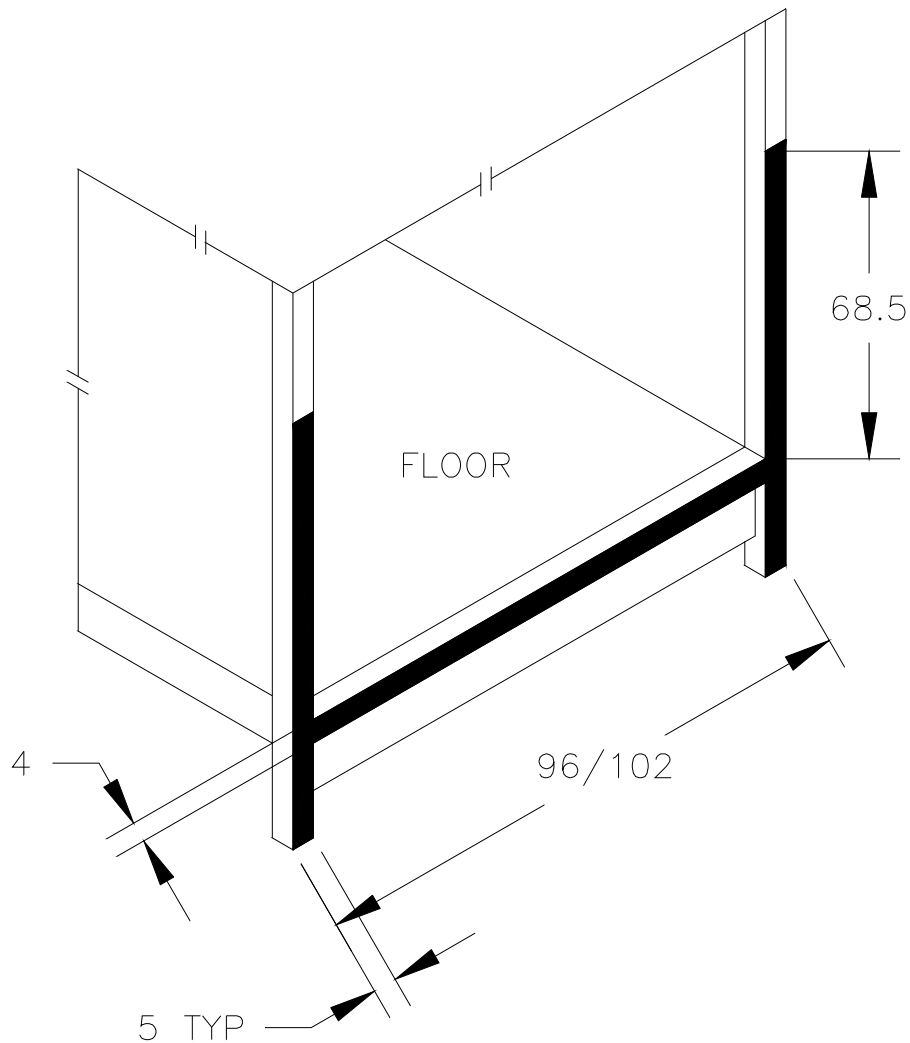

PREPARATION REQUIRED TO THE REAR OF THE VEHICLE BEFORE MOUNTING GATE TO VEHICLE

Cut off obstructions such as light guards and bumper plates that extend beyond the rear sill and rear posts in the areas as shown below. Remove the lights, if permissible. The FXD® has LED lights on the masts.

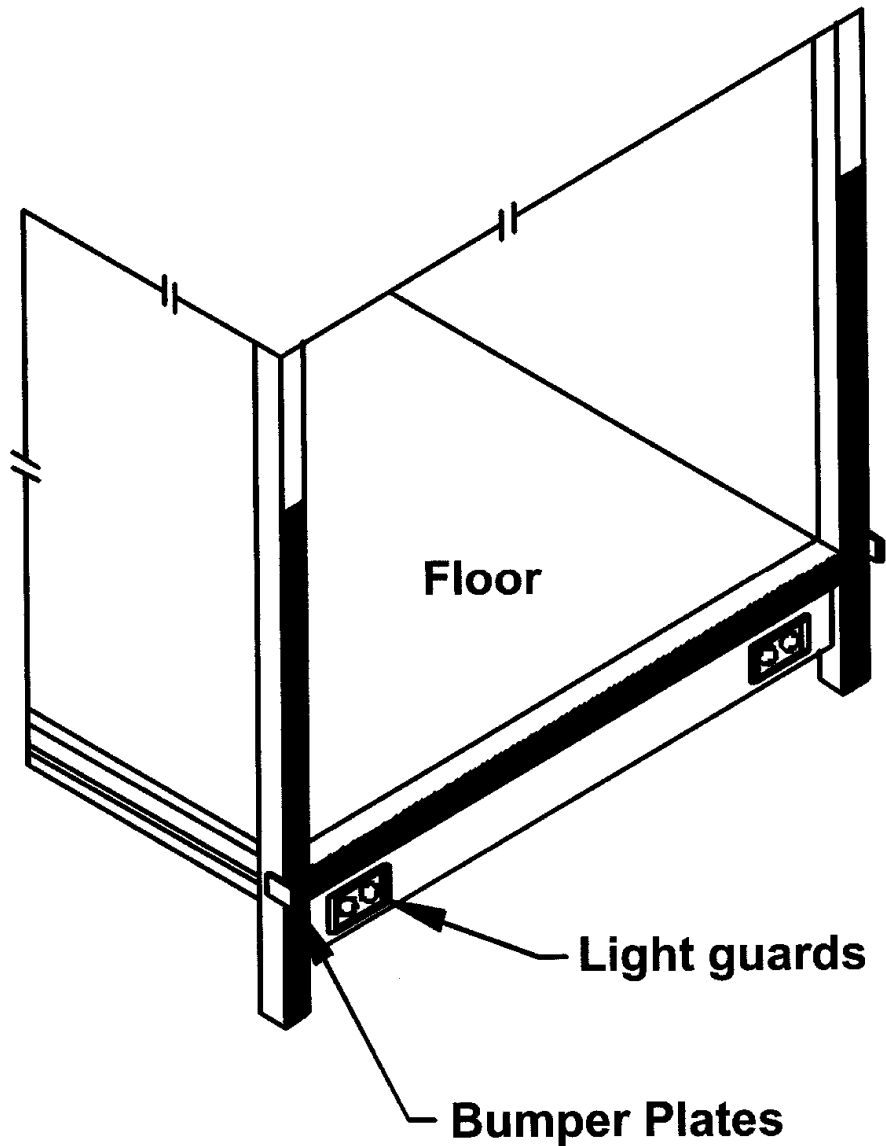

REMOVE METAL TO MAKE A FLUSH SURFACE

PREPARATION REQUIRED TO THE REAR OF THE VEHICLE BEFORE MOUNTING GATE TO VEHICLE

Use 1/4" flat stock as fillers to fill the step down area for the overhead door. Remove the door latch plate, so it can be reinstalled after the floor is filled in. Filler flat stock is not provided by Leyman Manufacturing Corporation.

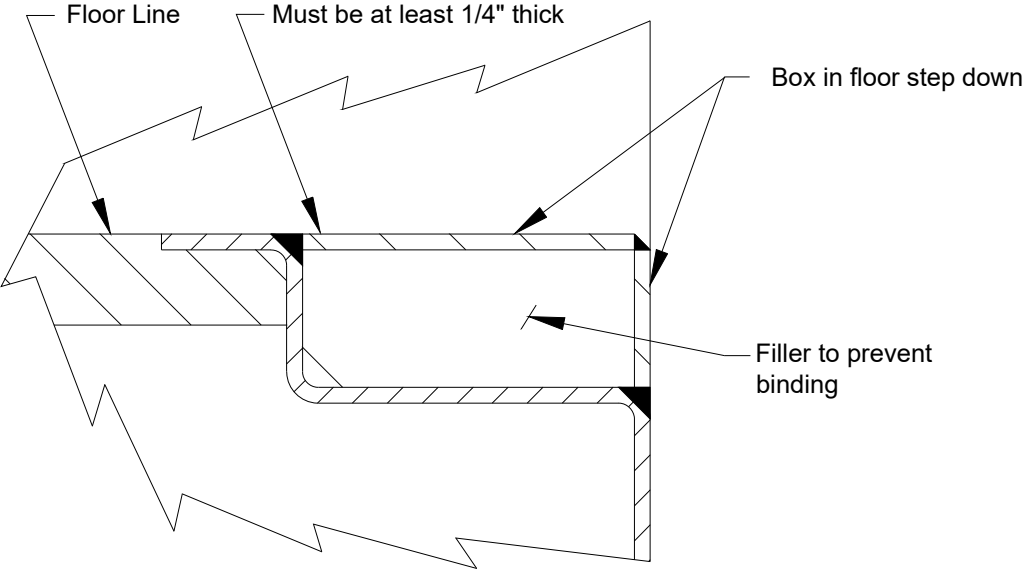
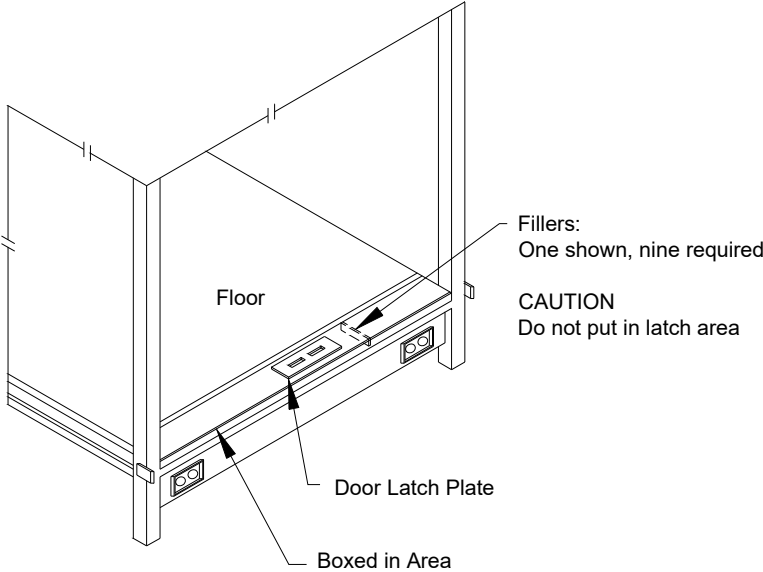

THE BACK OF VEHICLE MUST BE SQUARE

NOTE:

The back of the vehicle must be square to the ground within 1/2" deviation (see drawing). This can be checked with a plum bob. If there is any doubt, weld the FXD[®] temporarily in place, with the Bolt-On Kit attached to the rail gate, then unfold the platform, and lower the platform to ground level. The tip of the platform should touch the ground. If it does not, the gate can be shimmed out until it touches. Then follow all Bolt-On Kit and final welding instructions later.

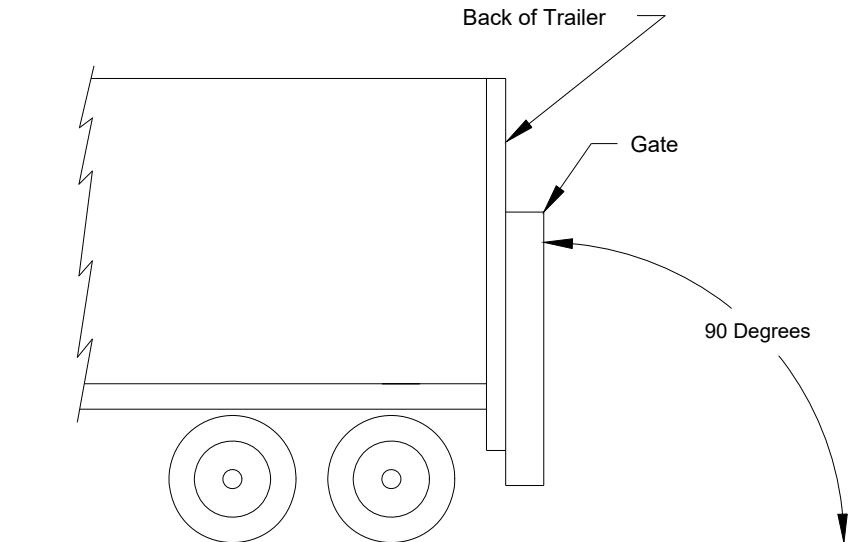

If the vehicle is not square; 4" x 5" long shims maybe used with varying thicknesses to fill the gap. see the "Welding Instructions"

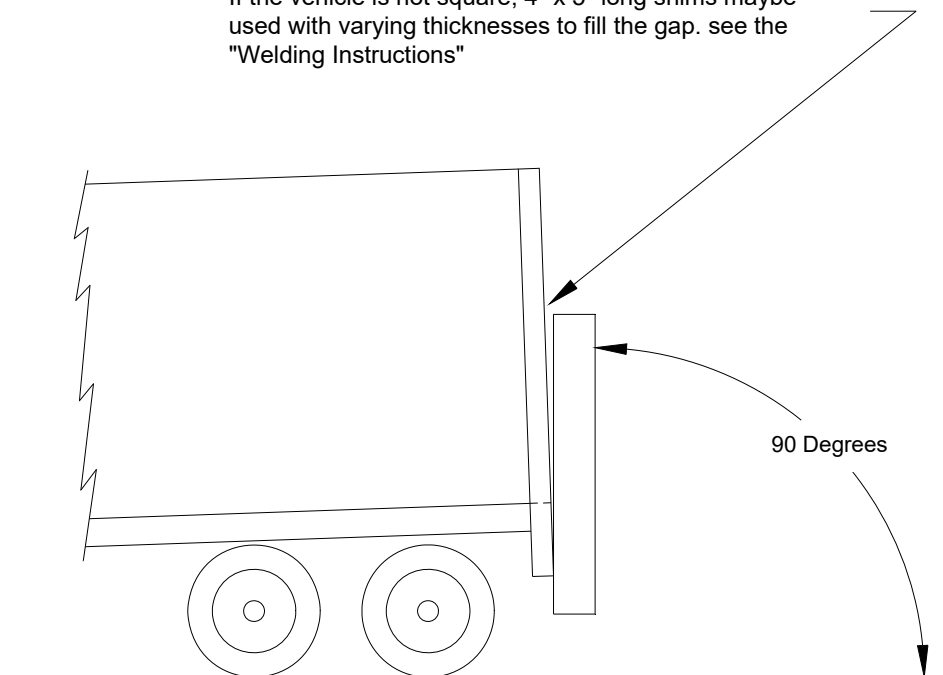

REINFORCEMENT FOR “BREAK-AWAY” BODIES

It is the installer’s responsibility to determine if a lift gate is being mounted on a “break-away” style body. If so, all of the bracing listed below must be added. Reinforcement parts are not supplied by Leyman Manufacturing Corporation, unless requested as an option.

NOTES:

1. Cut the bottom brace (Item#3) to length as needed to clear the wheels.
2. Cut the support (Item #4) to length as needed to fit behind the wheels. Cut the ends at 45 degrees.
3. Space supports (Item #8) evenly across the width of the body. Weld to bottom rear sill and the cross members.

| ITEM | QTY | DESCRIPTION | MATERIAL |
|------|-----|--------------|--------------------------------|
| 1 | 2 | Top Brace | St. Tube 1 ½” sq. x 1/8” x 60” |
| 2 | 2 | Gusset | H.R. Flat ¼” x 4” x 36” |
| 3 | 2 | Bottom Brace | St. Tube 2” sq. x 3/16” x 60” |
| 4 | 2 | Support | St. Tube 2” sq. x 3/16” x 40” |
| 5 | 12 | H.H. Bolt | 3/8” – 16 x 2 ½” |
| 6 | 12 | Hex Nut | 3/8” – 16 x 2 ½” |
| 7 | 24 | Washer | 3/8” |
| 8 | 4 | Support | H.R. Flat ¼” x 4” x 8” |

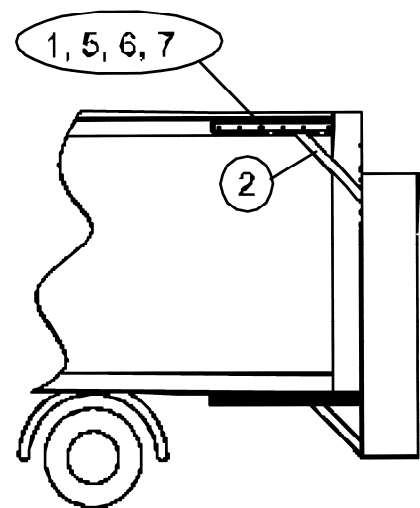
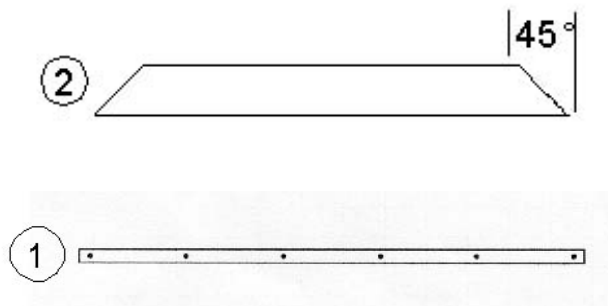

FLAT BED INSTALLATION

The FXD® rail gate Bolt-On Mounting Kit option is not suitable for flat bed installations; the standard version of the gate must be used. All flatbed installations require diagonal bracing from the flatbed to the rail gate masts.

UNPACKING THE FXD®

The FXD® is packaged to protect it during shipping. Do not remove any of the shipping material until the FXD® is standing upright on the floor and it is supported by placing the forks of a forklift under the shipping tube. Once this is done, remove only the shipping material as shown. The remaining items will not be removed until the gate is completely installed on the vehicle. Bolt-On Kit is NOT shown on gate mounting face.

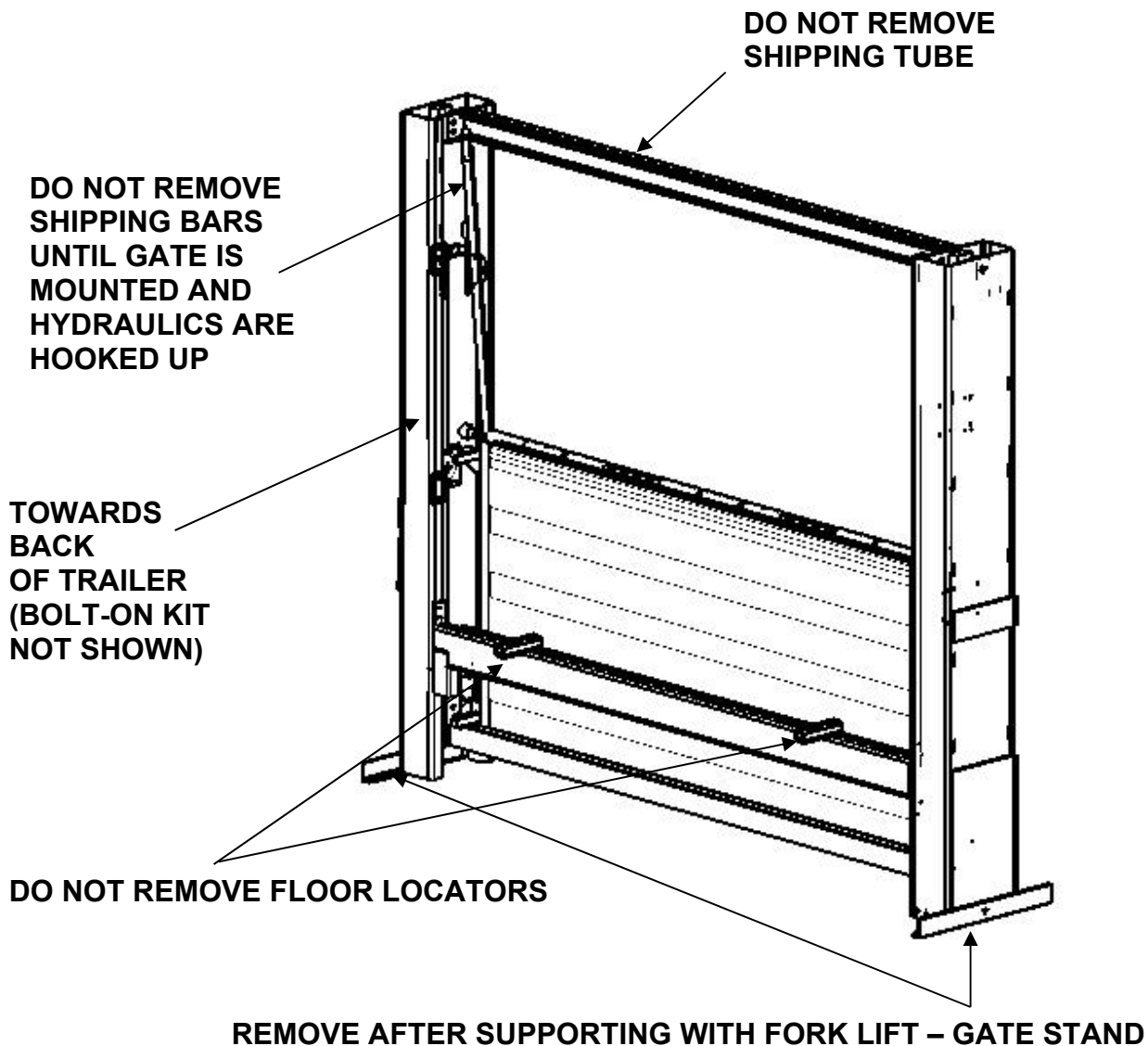

UNPACKING THE FXD® (cont.)

CAUTION

Always use a safety chain so the lift gate can not slide off the forks.
Lift FXD® slowly to vertical position, pictured below.

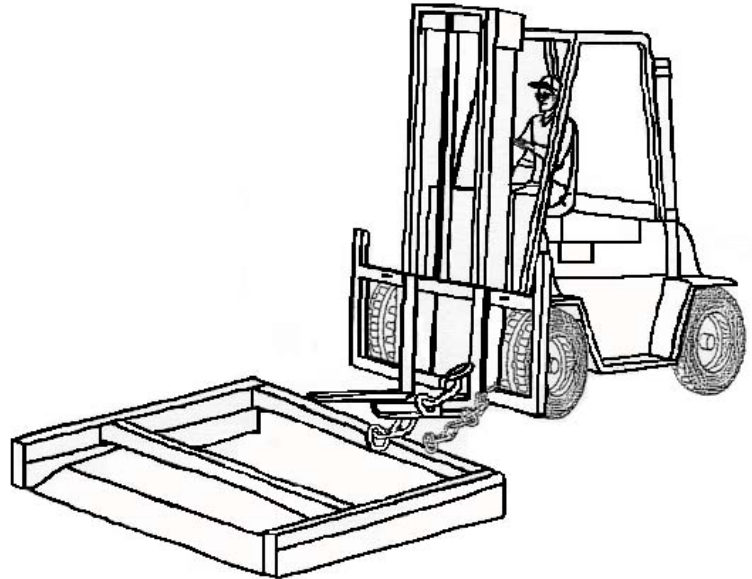

Clamp forks to the shipping tube as shown in picture below.

CAUTION

Do not remove shipping tube or the platform support bars until the hydraulics and power pack are hooked up and the gate, with Bolt-On Kit, is welded solid to the vehicle.

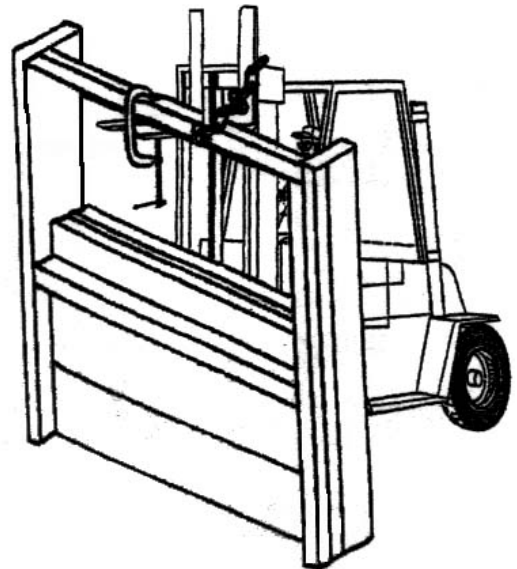

OPTIONAL BOLT-ON KIT for FXD®

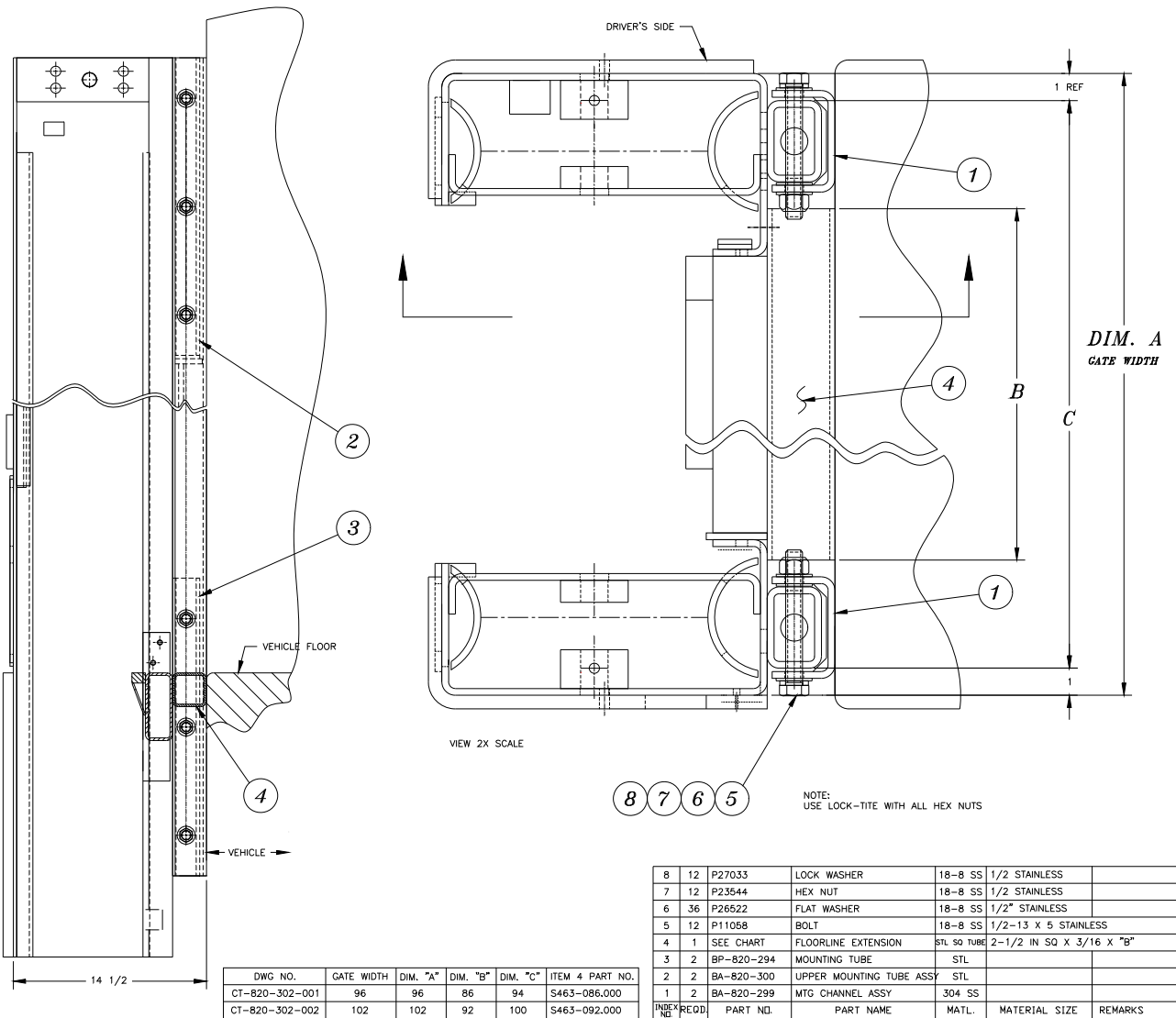

The primary purpose of the Bolt-On Kit is to avoid damage to the Extreme Shield® paint or galvanized finish during welding. Item 1, which must be welded to the vehicle, is unpainted stainless steel. The Bolt-On Kit comes fully assembled to the lift gate rails. It can remain assembled during installation.

IMPORTANT! When welding the stainless steel Mounting Channels (Item 1) to the rear frame of the vehicle (which could be either mild steel or stainless steel), you **must** use stainless steel welding wire in order to achieve good quality welds.

CAUTION! The Bolt-On Kit offsets the lift gate Outer Masts 2-1/2" from the rear face of the vehicle. This means that the Rear Impact Guard must be brought back within the 12" horizontal limit. The 1/2" thick steel bumper plates on the lift gate Outer Masts are excluded from the 12" maximum dimension. Consult trailer manufacturer for Rear Impact Guard kits that are available to make up for this 2-1/2".

HOISTING THE FXD[®] INTO POSITION FOR INSTALLATION

Lift the FXD[®] off the ground with a forklift and approach the vehicle.

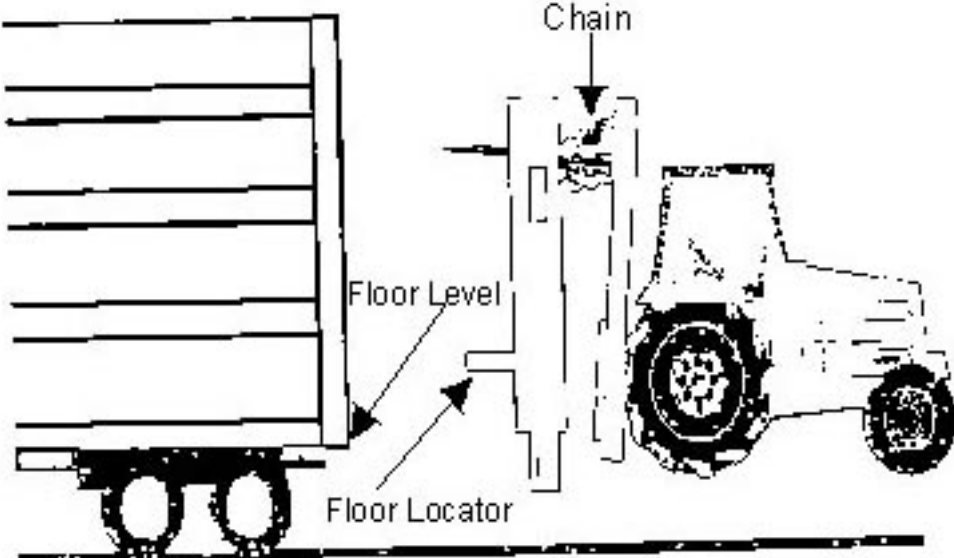

NOTE:
The floor locators must rest on the vehicle.

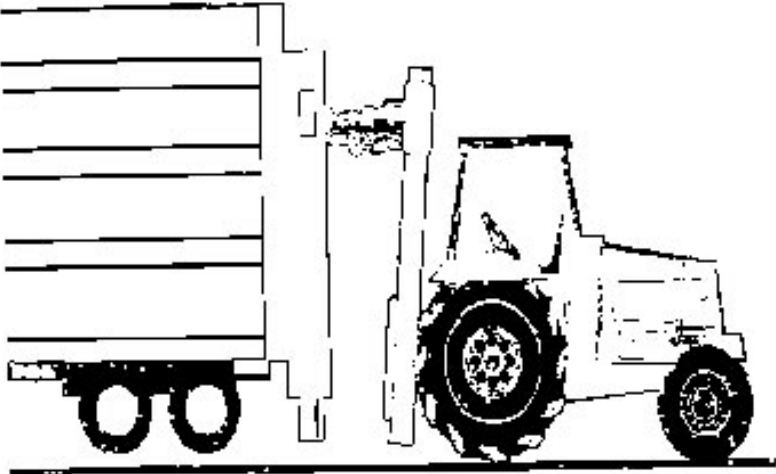

WELD FXD[®] TO VEHICLE

Center the FXD[®] on the vehicle. Once the gate is centered, and resting on the vehicle floor, weld stainless steel Mounting Channels on Outer Masts to vehicle.

Use ¼" fillet welds 2" long and spaced 10" apart on both inside and outside vertical surfaces of the Mounting Channels. No welds are required across the Floor Line Extension Tube (Item 4 on the Bolt-On Kit drawing, p.12)

The two vertical rails must be welded to Vehicle
both Inside and Outside

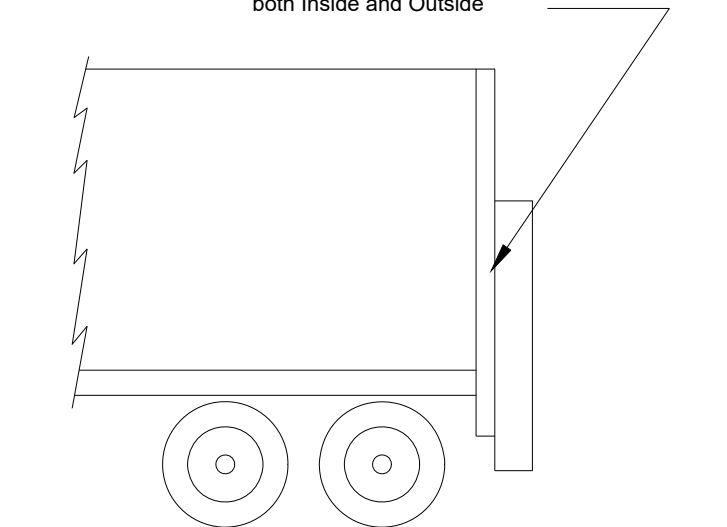

REMOVE FLOOR LOCATOR TUBES AND SHIPPING TUBE

Once the lift gate has been welded to the vehicle and meets previously stated specifications, remove floor locator tubes, unbolt the platform support straps while supporting the platform, and remove the shipping tube by unbolting.

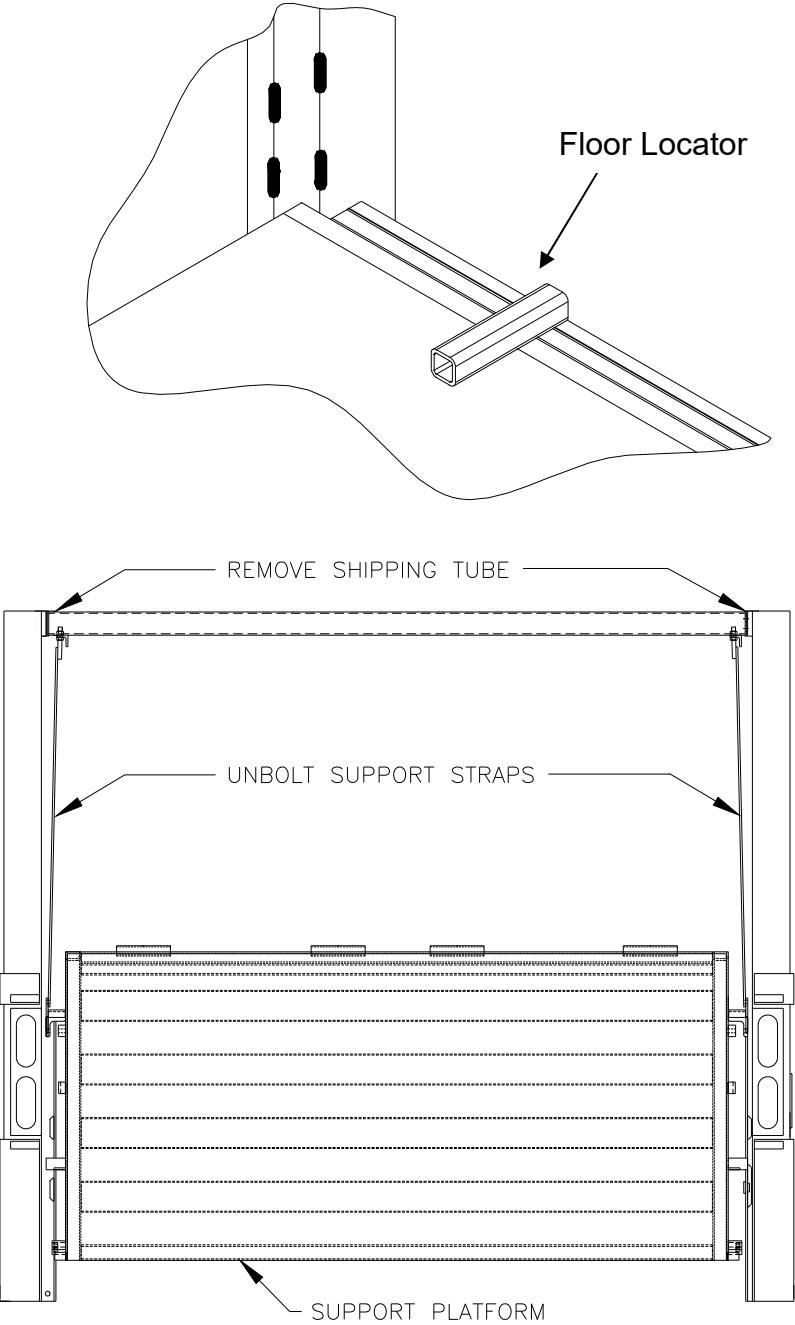

INSTALLING HEADER ENCLOSURE

The Header Kit is an optional item on FXD®. The general method of installation is shown here. More detailed instructions are on the next page. Attach Header Kit to vehicle using rivets supplied to prevent damage to Extreme Shield® paint. DO NOT WELD.

Measure the distance from the top of the mast to the vehicle header.

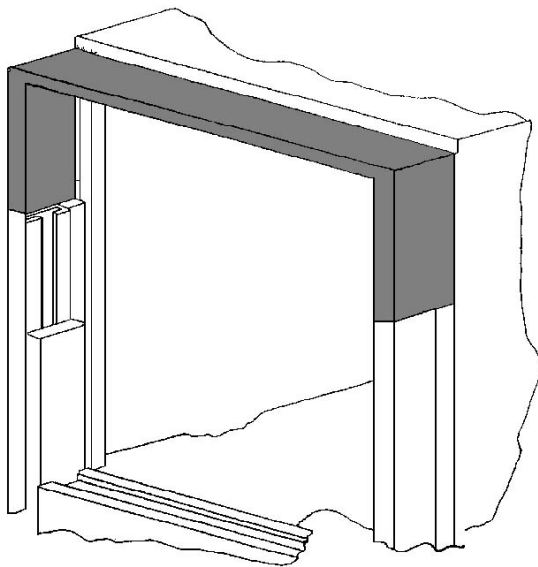
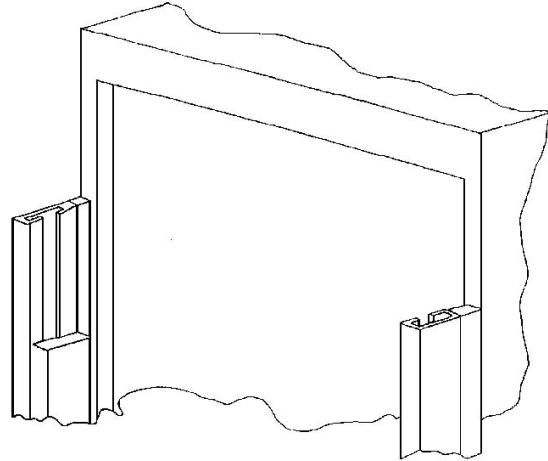

Trim the sides of the header enclosure to match the vehicle opening. Assemble header sides to top following instructions on next page. Use Extreme Shield touch-up paint kit where necessary.

3" channel at the top of the header faces to the rear, NOT against the vehicle header. The lights can be installed inside the channel.

INSTALLING HEADER ENCLOSURE (cont.)

CHANGES

| | |
|---|------------------------|
| A | WAS P17504 RJM 6/22/11 |
|---|------------------------|

INSTALLATION STEPS:

- 1) TRIM SIDES TO LENGTH REQUIRED. USE AN ABRASIVE CUTTING WHEEL TO MINIMIZE DAMAGE TO PAINT. TOUCH UP CUT ENDS USING THE EXTREME SHIELD PAINT KIT PROVIDED.
- 2) ASSEMBLE SIDES TO TOP USING CORNER STRAPS (ITEM 3). DRILL 0.259" HOLES ("F" DRILL) THROUGH HEADER PIECES AND ATTACH CORNER STRAPS USING RIVETS (ITEM 5).
- 3) LIFT HEADER ASSEMBLY ONTO TRAILER AND DRILL 0.259 ("F" DRILL) MOUNTING HOLES. IF TRAILER FACE IS STAINLESS STEEL, USE COBALT HIGH-SPEED STEEL TWIST DRILL. ATTACH USING RIVETS (ITEM 4).
- 4) IF VIEW OF TRAILER MARKER LIGHTS IS BLOCKED IN ANYWAY, MOVE LIGHTS ONTO 3" MOUNTING CHANNEL AT TOP OF HEADER.

| 5 | 16 | P49056 | 1/4 BLIND RIVET | 1/8 - 1/4 GRIP | |
|----------------------------------|-------|-----------------|---------------------|----------------|---------------|
| 4 | 31 | P49107 | 1/4 BLIND RIVET | 1/4 - 3/8 GRIP | |
| 3 | 2 | BP-820-303 | CORNER STRAP | | |
| 2 | 2 | BP-820-297 | HEADER FORMED SIDES | | |
| 1 | 1 | SEE CHART | HEADER TOP ASSY | | |
| INDEX NO. | REQD. | PART NO. | PART NAME | MATL. | MATERIAL SIZE |
| | | | REMARKS | | |
| LEYMAN MANUFACTURING CORPORATION | | | | | |
| TOLERANCE | | PART NAME | | | |
| FRACTIONS ± 1/32 | | HEADER ASSY FXD | | | |
| DECIMAL ± .005 | | w/ BOLT-ON KIT | | | |
| DR - HOLE ± .003-000 | | SCALE 1/10 | | | |
| ANGLE ± 1/2° | | TOTAL WEIGHT | | | |
| UNLESS OTHERWISE NOTED | | SH. | | | |
| | | DF | | | |

| PART NO | WIDTH | ITEM | REMARKS |
|----------------|-------|----------------|---------|
| BT-820-298-002 | 102 | BT-820-296-002 | |
| BT-820-298-001 | 96 | BT-820-296-001 | |
| | | | |

INSTALLING HEADER ASSY (w/BOLT-ON KIT) STAINLESS MOUNTING

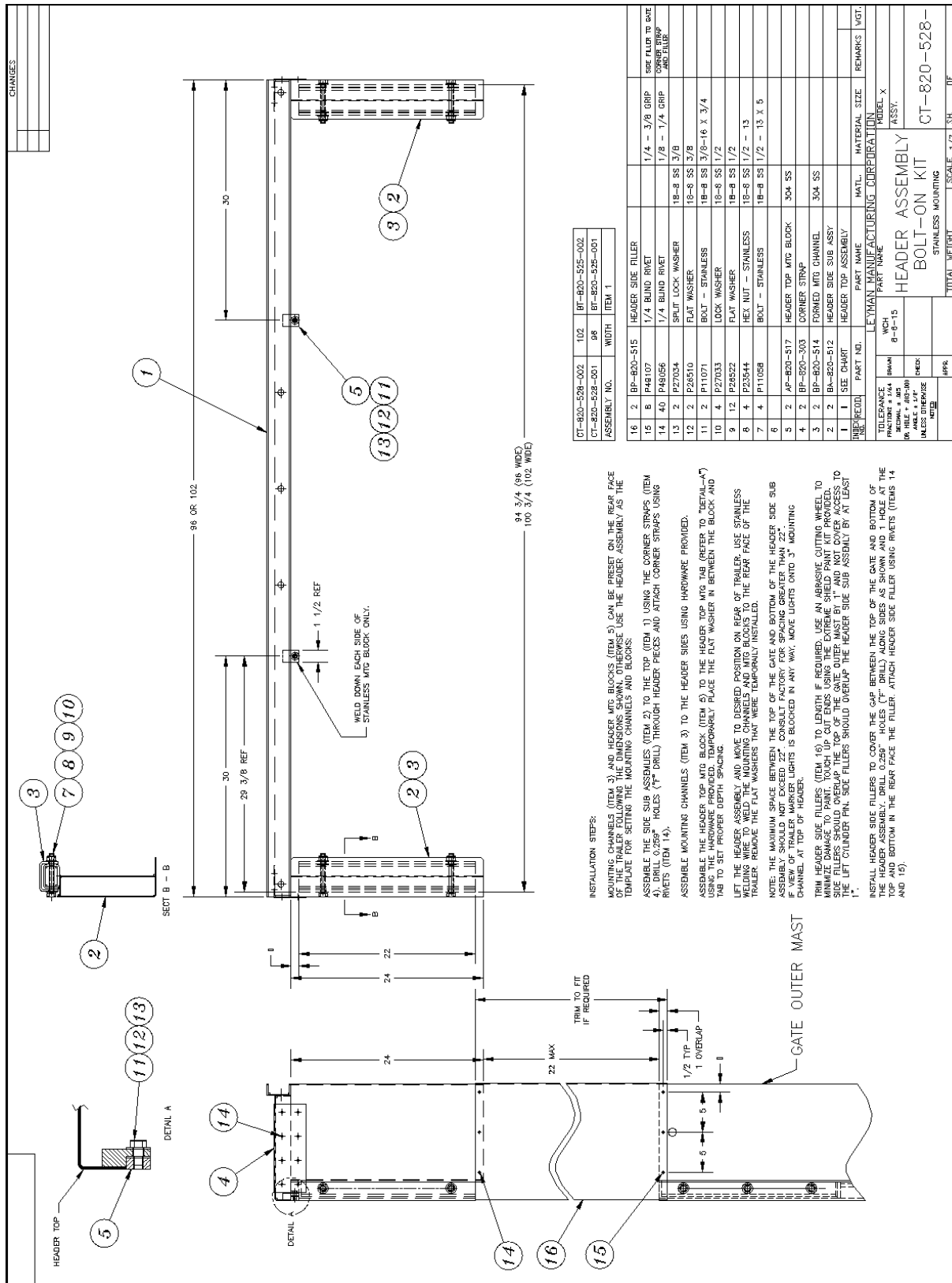

| ASSEMBLY NO. | WIDTH | ITEM 1 |
|----------------|-------|----------------|
| BF-820-528-002 | 102 | BF-820-525-002 |
| CT-820-528-001 | 96 | BF-820-525-001 |

| ITEM NO. | DESCRIPTION | QTY | MATERIAL | REMARKS |
|----------|-------------|-----|----------------------|---------|
| 16 | BP-820-515 | 2 | HEADER SIDE FILLER | |
| 2 | AP-820-517 | 2 | HEADER TOP MTC BLOCK | 304 SS |
| 3 | BP-820-303 | 2 | CORNER STRAP | 304 SS |
| 4 | BP-820-303 | 2 | CORNER STRAP | 304 SS |
| 5 | BP-820-514 | 2 | FORMED MTC CHANNEL | 304 SS |
| 6 | BP-820-512 | 2 | HEADER SIDE SUB ASSY | |
| 7 | BP-820-512 | 2 | HEADER SIDE SUB ASSY | |
| 8 | BP-820-512 | 2 | HEADER SIDE SUB ASSY | |
| 9 | BP-820-512 | 2 | HEADER SIDE SUB ASSY | |
| 10 | BP-820-512 | 2 | HEADER SIDE SUB ASSY | |
| 11 | BP-820-512 | 2 | HEADER SIDE SUB ASSY | |
| 12 | BP-820-512 | 2 | HEADER SIDE SUB ASSY | |
| 13 | BP-820-512 | 2 | HEADER SIDE SUB ASSY | |
| 14 | BP-820-512 | 2 | HEADER SIDE SUB ASSY | |
| 15 | BP-820-512 | 2 | HEADER SIDE SUB ASSY | |
| 16 | BP-820-512 | 2 | HEADER SIDE SUB ASSY | |

INSTALLATION STEPS:

1. MOUNTING CHANNELS (ITEM 3) AND HEADER MTC BLOCKS (ITEM 5) CAN BE PRESET ON THE REAR FACE OF THE TRAILER FOLLOWING THE DIMENSIONS SHOWN. OTHERWISE USE THE HEADER ASSEMBLY AS THE TEMPLATE FOR SETTING THE MOUNTING CHANNELS AND BLOCKS.

2. ASSEMBLE THE SIDE SUB ASSEMBLIES (ITEM 2) TO THE TOP (ITEM 1) USING THE CORNER STRAPS (ITEM 4). DRILL 0.259" HOLES (1" DRILL) THROUGH HEADER PIECES AND ATTACH CORNER STRAPS USING RIVETS (ITEM 14).

3. ASSEMBLE MOUNTING CHANNELS (ITEM 3) TO THE HEADER SIDES USING HARDWARE PROVIDED.

4. ASSEMBLE THE HEADER TOP MTC BLOCK (ITEM 5) TO THE HEADER TOP MTC TAB (REFER TO DETAIL-A) USING THE HARDWARE PROVIDED. TEMPORARILY PLACE THE FLAT WASHER IN BETWEEN THE BLOCK AND TAB TO SET PROPER DEPTH SPACING.

5. LIFT THE HEADER ASSEMBLY AND MOVE TO DESIRED POSITION ON REAR OF TRAILER. USE STAINLESS WELDING WIRE TO WELD THE MOUNTING CHANNELS AND MTC BLOCKS TO THE REAR FACE OF THE TRAILER. REMOVE THE FLAT WASHERS THAT WERE TEMPORARILY INSTALLED.

6. NOTE THE MAXIMUM SPACE BETWEEN THE TOP OF THE GATE AND BOTTOM OF THE HEADER SIDE SUB ASSEMBLY SHOULD NOT EXCEED 22".

7. IF ASSEMBLY SPACE IS LIMITED, CONTACT FACTORY FOR SPACING GREATER THAN 22".

8. CHANNEL AT TOP OF HEADER.

9. TRIM HEADER SIDE FILLERS (ITEM 16) TO LENGTH IF REQUIRED. USE AN ABRASIVE CUTTING WHEEL TO MINIMIZE DAMAGE TO PAINT. TOUCH UP CUT ENDS USING THE EXTREME SHIELD PAINT KIT PROVIDED.

10. SIDE FILLERS SHOULD OVERLAP THE TOP OF THE GATE OUTER MAST BY 1" AND NOT COVER ACCESS TO THE LIFT CYLINDER PIN. SIDE FILLERS SHOULD OVERLAP THE HEADER SIDE SUB ASSEMBLY BY AT LEAST 1".

11. INSTALL HEADER SIDE FILLERS TO COVER THE GAP BETWEEN THE TOP OF THE GATE AND BOTTOM OF THE HEADER SIDE SUB ASSEMBLY. REFER TO DETAIL B FOR THE CORRECT POSITION OF THE FILLERS.

12. TOP AND BOTTOM IN THE REAR FACE THE FILLER. ATTACH HEADER SIDE FILLER USING RIVETS (ITEMS 14 AND 15).

MOUNTING POWER UNIT FRAME

Mount the power unit frame as close to the electrical source as possible. Center the power unit frame under the vehicle and weld to all “I” beams that the power unit frame touches. Use full welds. When installing the power unit frame to a truck, you may mount it on either side, however, we recommend the installation on the curbside of the vehicle.

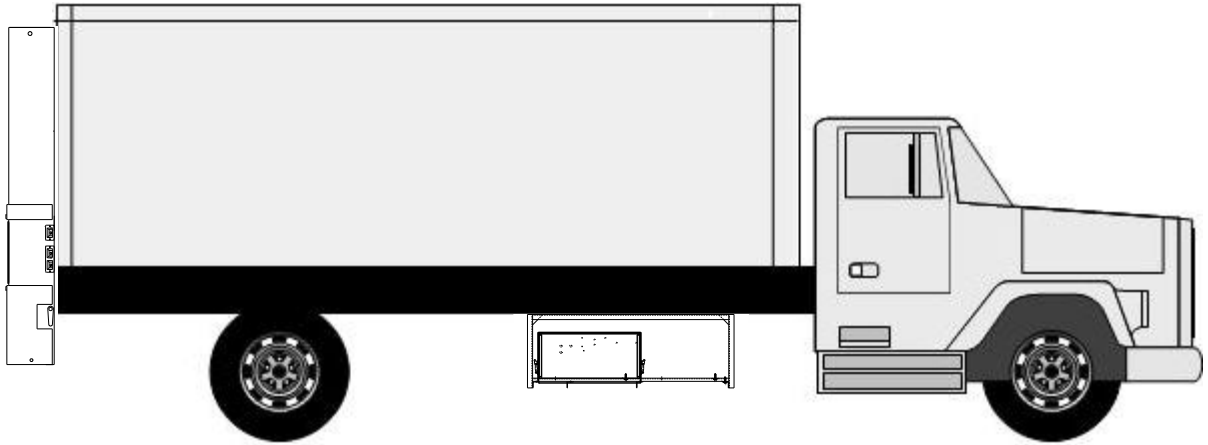

When mounting power unit frame on truck body cross-members, Installer **MUST INSTALL** a ground wire between the power unit frame and the truck chassis ground. Wire **NOT** supplied by Leyman.

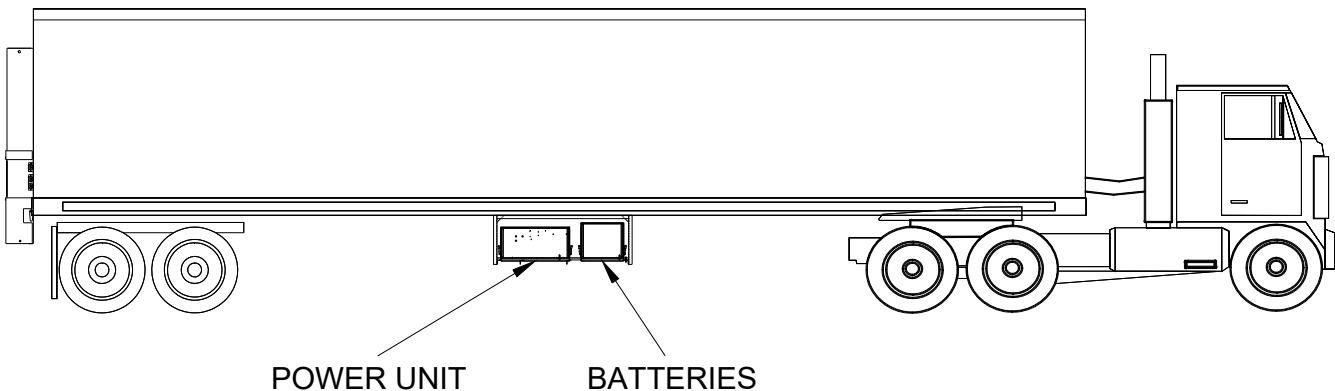

GROUNDING RECOMMENDATIONS FOR TRACTOR/ TRAILER

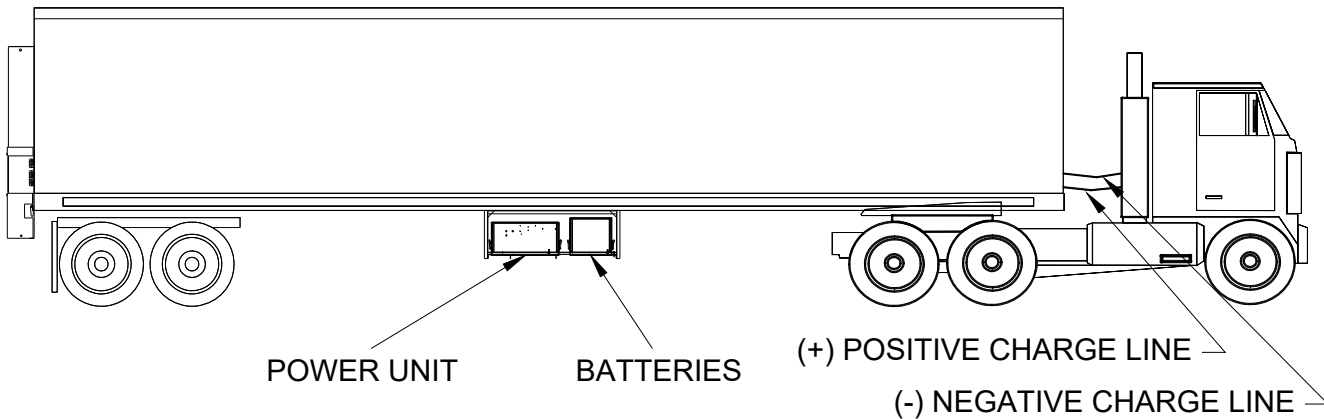

The MAINTENANCE MINDER 2[®] controller requires that a minimum of 8 volts be maintained under load in order for the FXD[®] power unit to operate. Using a single positive cable and utilizing the fifth wheel plate as the ground may not be adequate. Therefore, our recommendation for grounding tractor/trailers with an FXD[®] gate is as follows:

Two (2) cables: one (1) positive and one (1) negative, both running to the tractor batteries.

NOTE:

The use of a battery charger as the sole power source to operate a FXD[®] is unauthorized and will prevent the FXD[®] from working properly. The lift gate must always be operated in conjunction with at least one (1) 12-volt dual purpose heavy-duty lift gate battery. A minimum of 10.5 volts must be maintained in order for the valves to operate.

CHARGE LINE

When installing the charge line, be sure the cable goes through three (3) "1" beams at the very least, past the fifth wheel plate and through the clear vinyl loom. Mount the remaining cable with loom clamps and self-tapping screws to the "1" beams.

USE "2" GAUGE CABLE AT MINIMUM

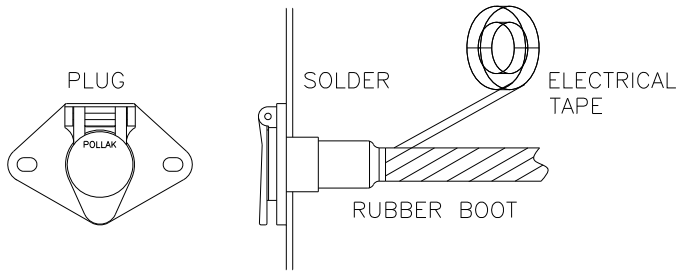

WE RECOMMEND THAT YOU USE AT LEAST A 90 AMP ALTERNATOR ON THE TRACTOR TO RECHARGE THE BATTERIES ON THE FXD®.

NOTE: We recommend that you take the vehicle to a refrigeration distributor if the reefer unit will be used for recharging

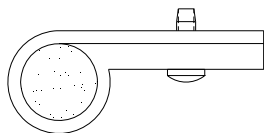
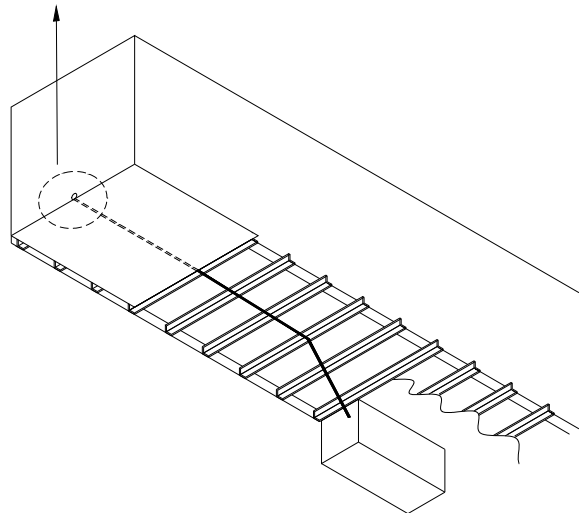

TRACTOR PLUG

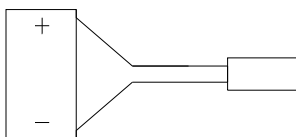

The plug that is on the tractor must have a hot wire and ground wire to the lug that plugs into the trailer.

BATTERY HOOK UP

We recommend batteries with the following specifications:
 12 Volt Heavy Duty Lead Acid Dual Purpose or AGM
 B.C.I. Group – Size 31
 Terminal Type – Threaded Stud
 Cold Cranking Amps – 580 Min.

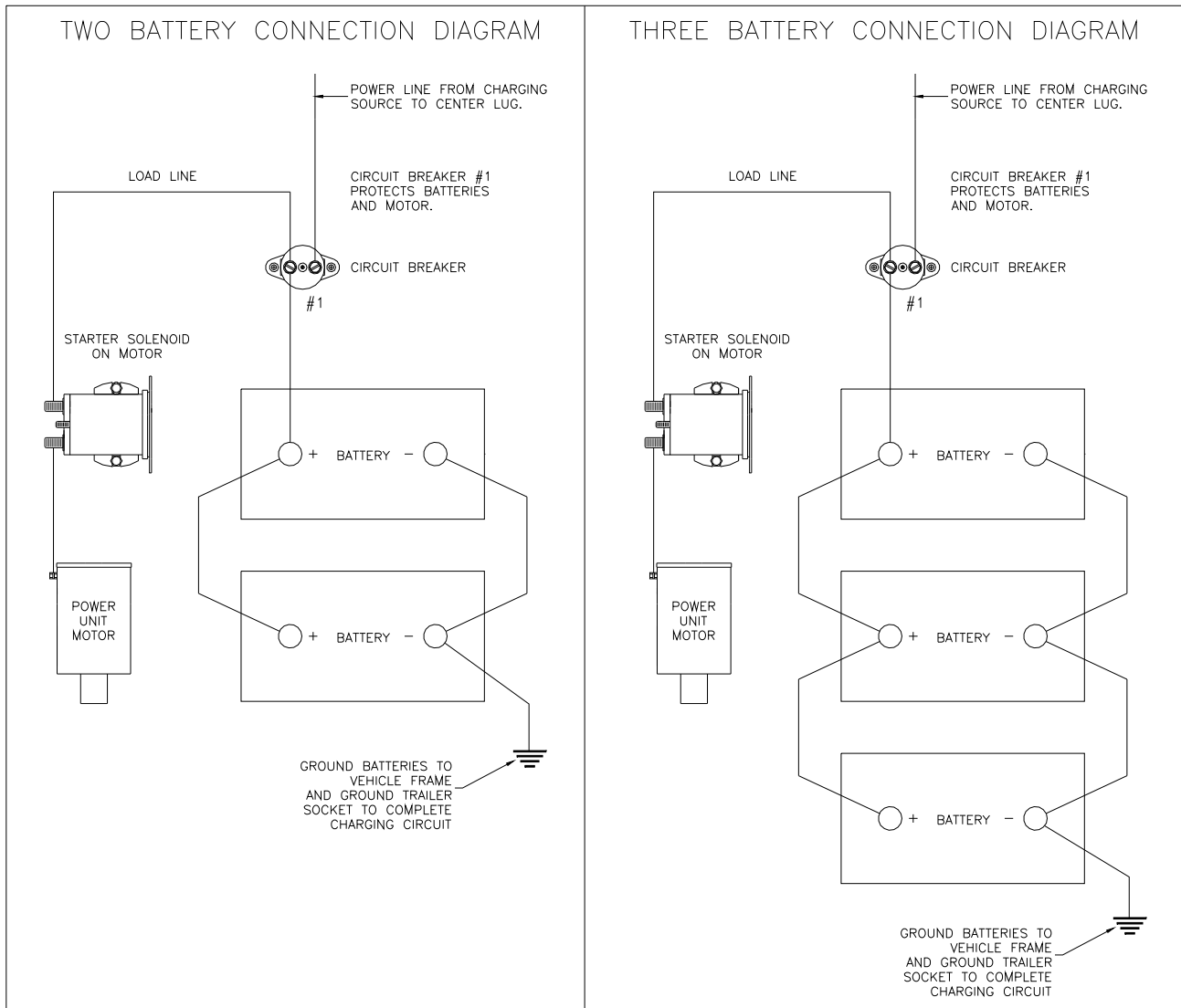

Note: placing the charge line(s), load line(s) and ground cable on the same battery will result in unequal charging and discharging of the batteries. The (+) and (-) connections must be made across the entire battery bank (one connection on the first battery and the other connection on the last battery).

Place rubber pads under each battery to prevent movement, and securely tighten Battery Clamp.

FAILURE TO USE CORRECT BATTERIES WILL VOID WARRANTY

RECOMMENDED HYDRAULIC OILS*

| HYDRAULIC OILS | MANUFACTURER | TYPE | TEMP. RANGE |
|------------------------------------|--|-----------------|--------------------|
| Level 1 Normal Conditions | Mobil | DTE 10 EXCEL 15 | -15° F to + 150° F |
| | Shell | TELLUS S2 VX 15 | -15° F to + 150° F |
| | Chevron | RANDO HDZ 15 | -15° F to + 150° F |
| Level 2 Cold Conditions | Mobil | AERO-HFA | -50° F to + 80° F |
| | Shell | AERO FLUID #4 | -50° F to + 80° F |
| | Chevron | 5606A | -50° F to + 80° F |
| HYDRAULIC TANK CAPACITY | | | |
| 3 gallons | | | |
| LUBRICATION | | | |
| Grease | Level 1 Normal Conditions NLGI #2 Lithium base grease Level 2 Cold Conditions NLGI #1 Lithium base grease DO NOT USE CHASSIS or 5 th WHEEL GREASE | | |
| Rollers at Inner Masts | CAUTION! Do not over-grease to avoid seal damage | | |
| Hinge Barrels (center of platform) | W.W. Grainger – Part #6Y834 – Needle Nose Adapter | | |
| Retention Ramp hold-up tab shaft | W.W. Grainger – Part #6Y834 – Needle Nose Adapter | | |
| Dry Lubricant, if needed | ZEP45 (do not use corrosive lubricants like WD40, etc.) | | |

*ISO 15 petroleum-based fluid required; see chart for manufacturer cross reference. If necessary, use higher viscosity oil when temperatures are near 100° F.

* **DO NOT USE brake fluid or ATF.**

LIFT GATE SPECIFICATION

| BATTERIES |
|--|
| Two (2) 12 V D.C. Group 31 Heavy Duty Lead Acid Dual Purpose or AGM |
| ELECTRICAL COMPONENTS CONNECTIONS |
| Use Fluid Film Rust & Corrosion Protection by Eureka, except on Start Solenoid On Start Solenoid, use Color Guard by Loctite, or Liquid Electrical Tape |
| AMPERAGE DRAW OF MOTOR |
| When raising platform (empty) approximately 130 AMPS @ 13.5 volts. At bypass approximately 240 AMPS @ 13.5 volts |
| LIFTING PRESSURE SETTING |
| With platform at floor level and pump in bypass 2500 PSI Power down circuit in bypass 800 PSI |
| MINIMUM VEHICLE FLOOR HEIGHT LADEN |
| With 42" Inner Platform – vehicle floor height 46" |
| MAXIMUM VEHICLE FLOOR HEIGHT UNLADEN |
| With 42" Inner Platform – vehicle floor height 56" |
| APPROXIMATE TIMES EMPTY AT 80° F WITH 2 GROUP 31 BATTERIES |
| Time up: 24 – 26 seconds Time down (gravity down): 24 –26 seconds Time down (power down): 14 – 17 seconds |

CONNECTING SWITCH WIRING TO POWER UNIT

The FXD® arrives with the electric wiring connected to both the inside and outside toggle switches. Unroll and secure the wire to the underside of the “I” beams (pictured below) using the loom clamps and self-tapping screws. Then route cable through power unit box cord grip and connect all leads with fork terminals to the terminal strips on the rear and right side walls.

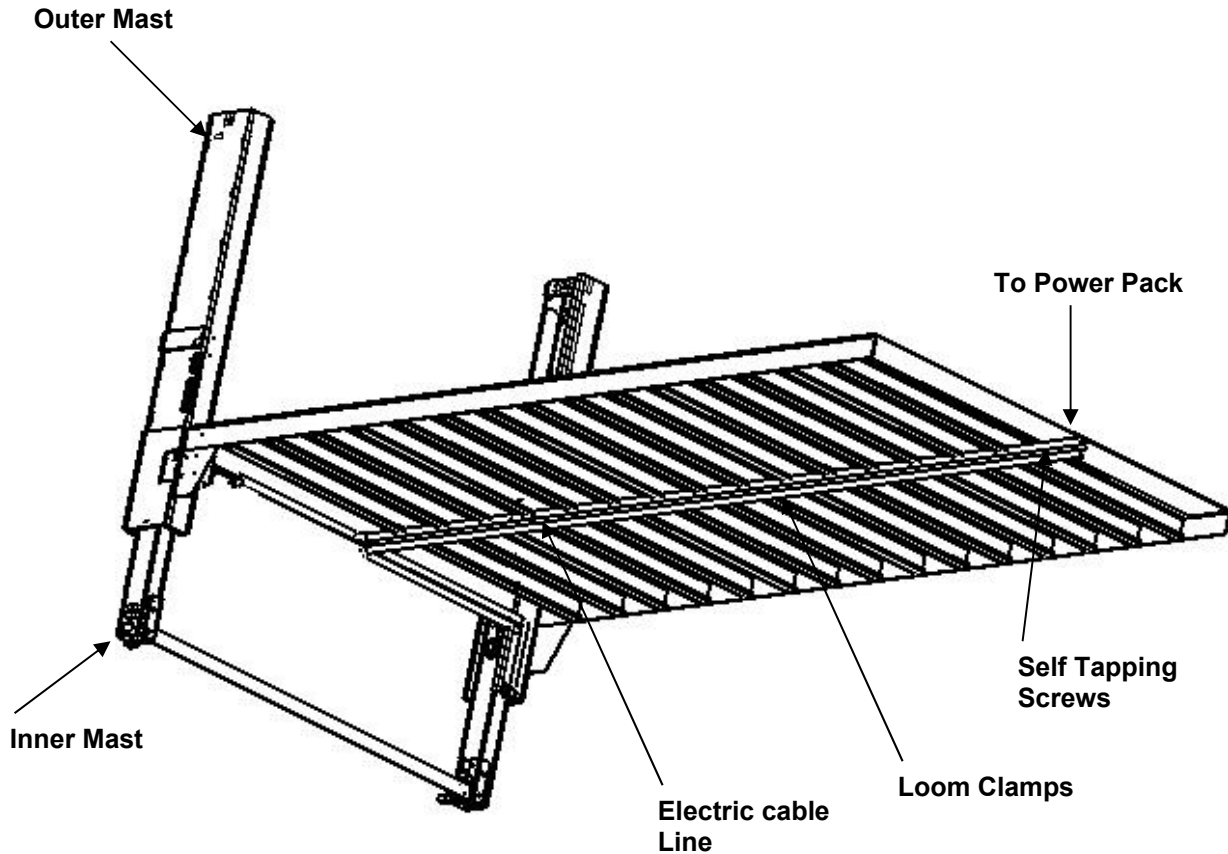

Wire mounts to underside of “I” beams

DUAL POWER UNIT CONNECTIONS

Match wire colors of the switch harness to wire colors on the terminal strips inside the power unit enclosure, paying specific attention to red and white wires – there are plain red and white wires, and red and white wires with a black tracer line on the insulation. Red with tracer and white with tracer wires connect to the terminal strip on the right-hand wall of the power unit enclosure.

Improperly connecting red with tracer and white with tracer to the red and white wires of the terminal strip on the rear wall will result in the lift gate not operating correctly.

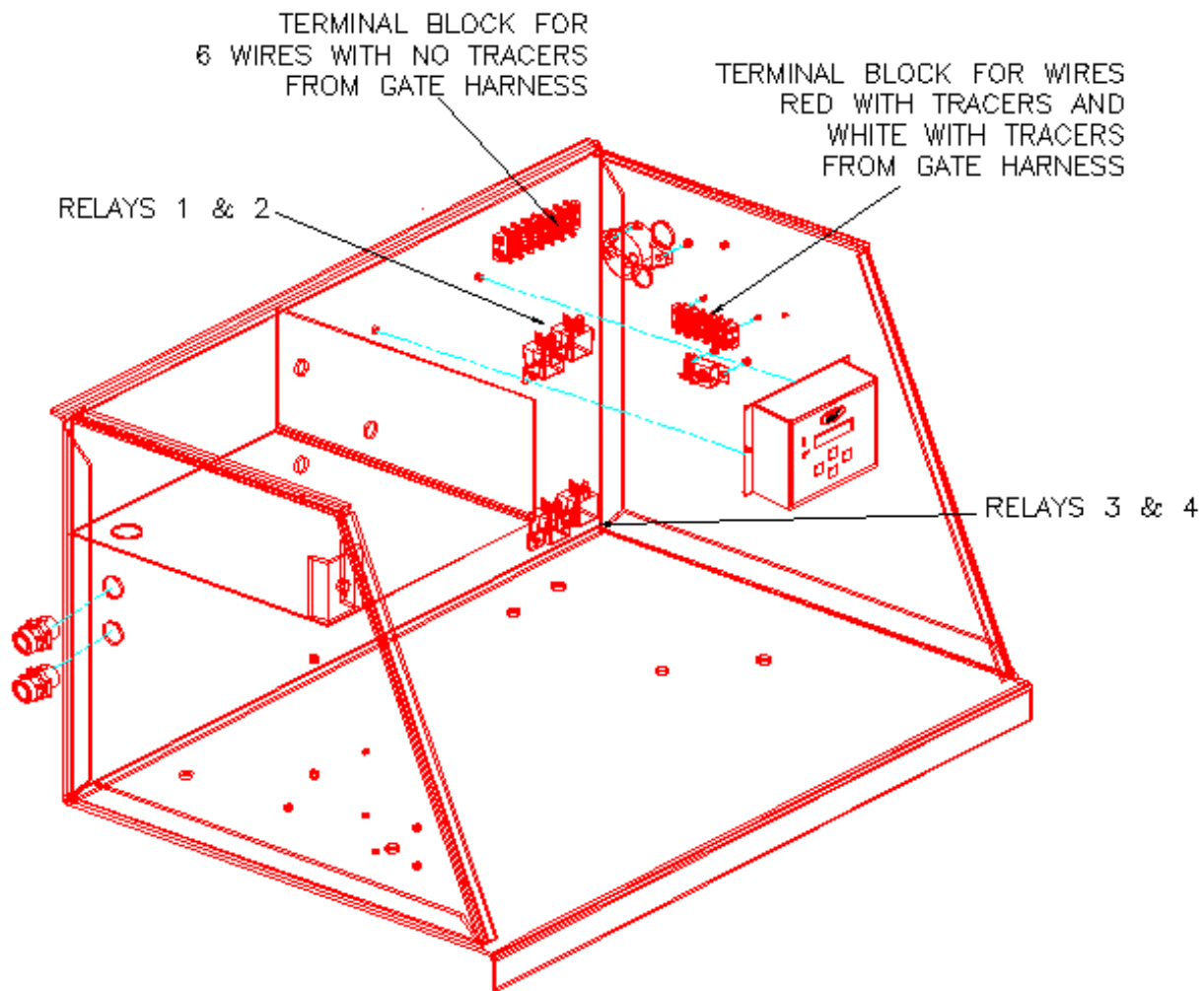

HYDRAULIC LINES

Up Line: First fill both tanks with a recommended hydraulic oil to within 4" from the top. Then connect one of the hydraulic lines to one of the exit ports of the equalizer valve behind the power unit. Take the second up/down line and connect it to the other exit port. Run both lines back to the gate. **Before connecting to bulkhead elbows on gate, run the power unit to fill the lines with oil.** Next, remove the caps on the bulkhead elbows at the bottom of the left Outer Mast and connect the hydraulic lines. See sketch on next page for port identification. Elbow fittings are provided with the hose kits to route the hoses straight up from the rail gate mast to the vehicle cross-members, if desired. Now, attach the hydraulic lines to the "I" beams with the loom clamps and self-tapping screws that are provided in the lift gate kit.

Down Line: Connect the hydraulic line to the bulkhead fitting mounted at the back of the power unit box and run the "down" line back to the bulkhead elbow located at the bottom of the left Outer Mast. **Before connecting to the elbow, run the power unit to fill the hydraulic line with oil.** Next, remove the cap at the elbow and connect the hydraulic line. See sketch on next page for port identification. Now, attach the hydraulic line to the "I" beams with the loom clamps and self-tapping screws that are provided with the lift gate kit.

Power Fold Line: Connect the hydraulic line to bulkhead fitting mounted at the back of power unit box and run the line back to the bulkhead elbow at the bottom of the left Outer Mast. Make sure this elbow is the one connected to the hydraulic line that is hooked up to the folding cylinder. **Before connecting to the elbow, run the power unit to fill the line with oil.** Next, attach the hydraulic line to the "I" beams with the loom clamps and self-tapping screws provided with the lift gate kit.

NOTE:

This procedure should minimize the amount of air trapped in the fold cylinder or hydraulic line. If the gate does not raise and lower smoothly or unfold and fold smoothly, see the page on bleeding the cylinders.

Oil Level Check: Unfold the platform and run to the full up position and recheck the oil level in the power unit. Oil level should be 4" from top of tank, wait several minutes for oil level to even out.

HYDRAULIC LINES (Cont.)

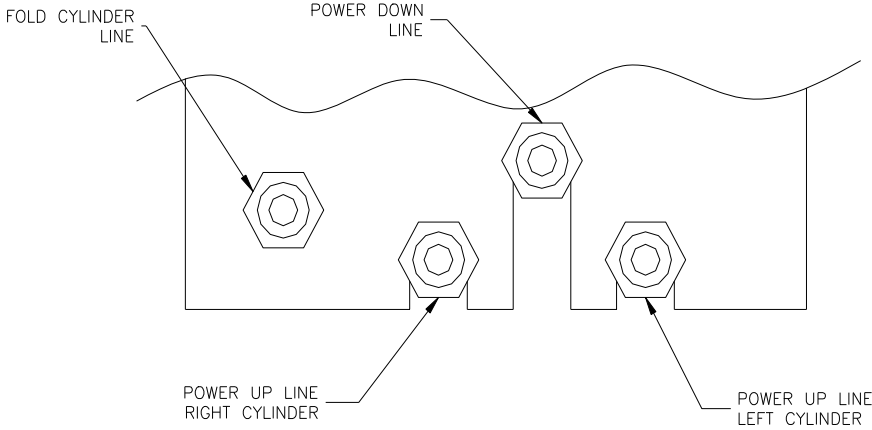

BOTTOM OF LEFT OUTER MAST
VIEW FROM BACK OF THE GATE

TORQUE ALL HOSE CONNECTIONS TO 18 - 20 FT-LBS

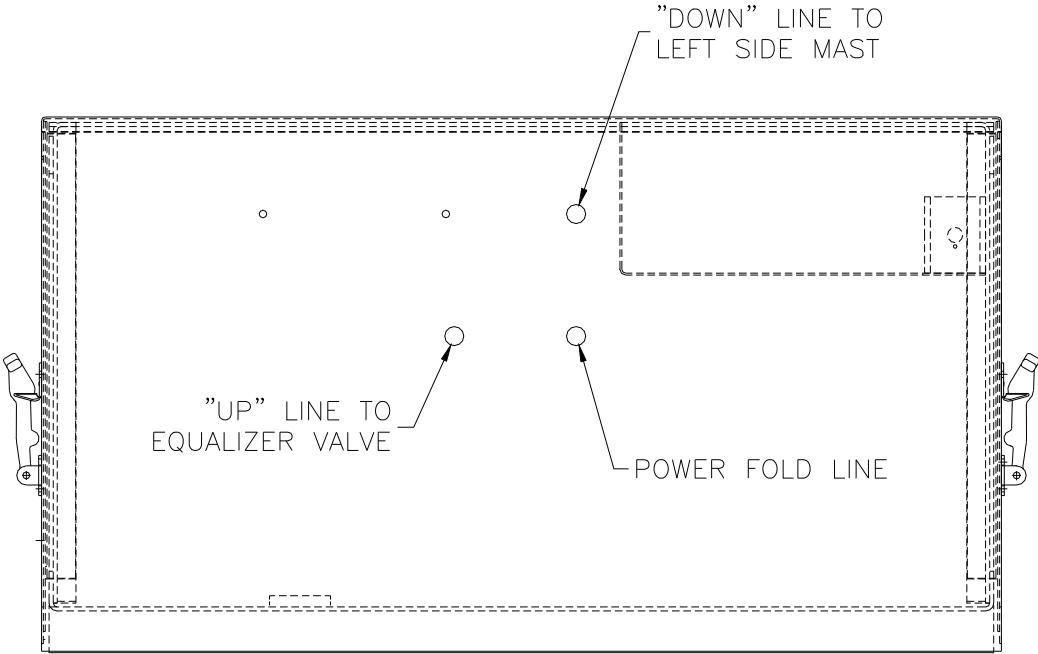

CONNECTIONS AT REAR OF POWER UNIT BOX

BLEEDING THE LIFT CYLINDERS

The FXD® is shipped with the cylinders pre-filled with hydraulic fluid from the factory. *The cylinders must be bled before making any other adjustments.*

To Bleed the Lifting Cylinder – Bottom Side:

1. Unfold and lower the platform to the full down position. **CYLINDERS SHOULD BE EXTENDED TO THEIR FULL LENGTH (GATE EXTENDED DOWN 56”) TO REMOVE AS MUCH AIR FROM THE BOTTOM SIDE OF THE CYLINDER AS POSSIBLE. DEPENDING ON THE FLOOR HEIGHT OF THE VEHICLE, IT MAY BE NECESSARY TO RAISE THE BODY OF THE VEHICLE OR LOWER THE GATE PLATFORM INTO A PIT TO ACHIEVE MAXIMUM CYLINDER EXTENSION.**
2. Loosen the plugs in the back ports (ports closest to the vehicle body), but do not remove completely.
3. Activate the pump just long enough to produce an air-free stream of oil from the ports.
4. Re-tighten the plugs in the ports, raise the platform to the full up position, and check the oil level in the reservoir tank. The oil level should be approximately 4” from top of the tank.

To Bleed the Lifting Cylinders – Top Side

1. Unfold and raise the platform to the full up position to remove as much air from the top side of the cylinder as possible.
2. Loosen the plugs in the front ports (ports furthest from the vehicle body) but do not remove completely.
3. Activate the pump (DOWN) just long enough to produce an air-free stream of oil from the ports.
4. Retighten the plugs in the ports, raise the platform to the full up position if not already there, and check the oil level in the reservoir tank. The oil level should be approximately 2” from top of the tank for DUAL power units.

NOTE: FOR POWER DOWN GATES, OIL LEVEL SHOULD ALWAYS BE CHECKED WITH THE PLATFORM UNFOLDED AND RAISED ALL THE WAY UP.

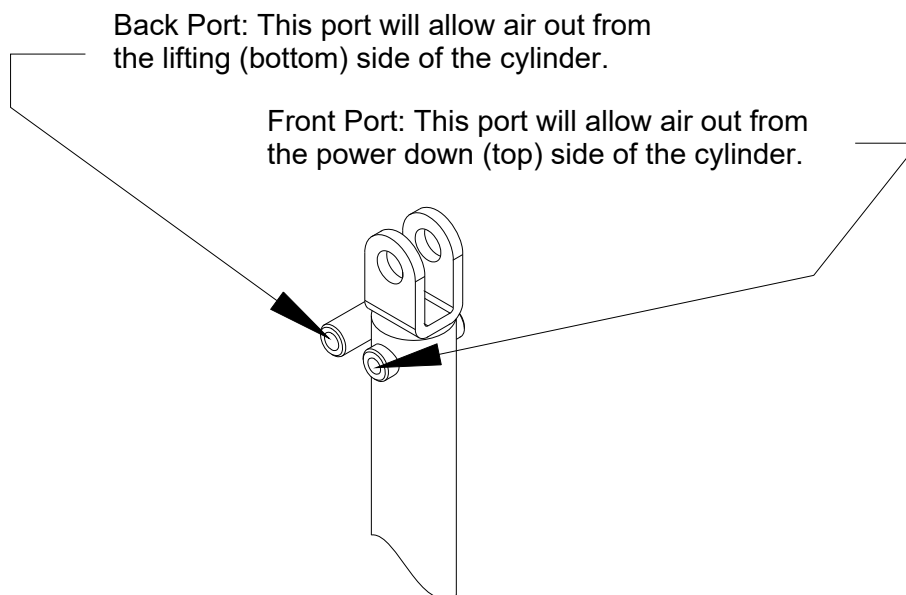

TO BLEED THE POWER FOLD CYLINDER

1. Unfold and lower the platform down to the ground.
2. Loosen the hose at the cylinder but do not remove completely.
3. Activate the pump just long enough to product an air free stream of oil from the hose.
4. Re-tighten the hose and check the oil level in the reservoir tank. Note: hold line while tightening to ensure it does not twist.
5. Fold and unfold the platform several times. The platform should now fold and unfold smoothly.

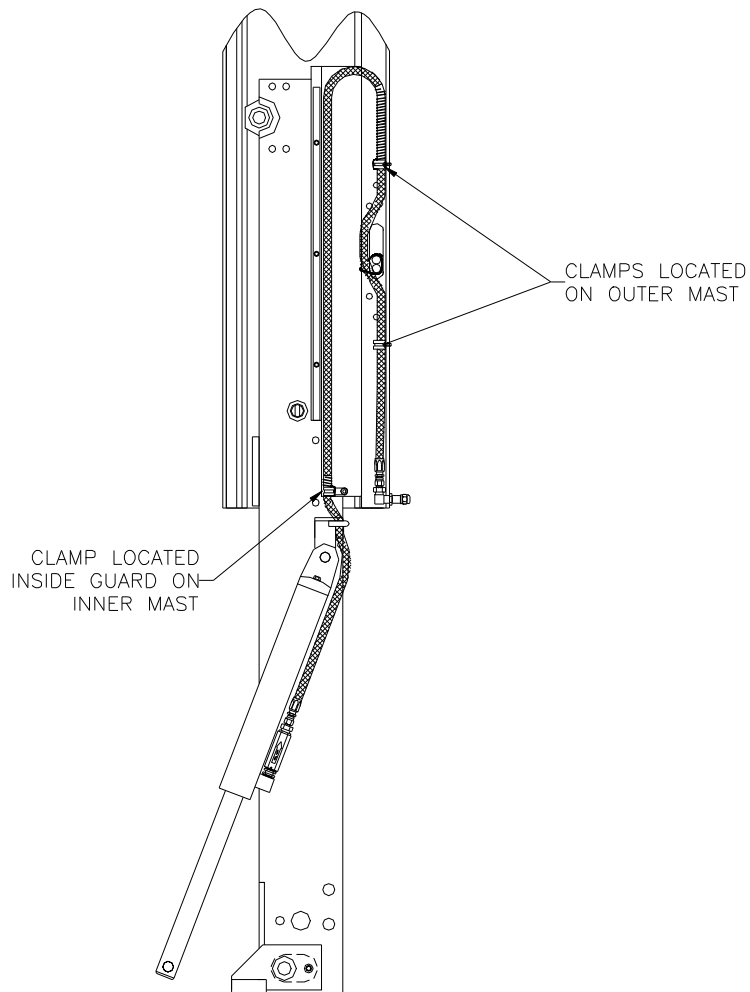

CHECK OIL LEVEL AFTER BLEEDING THE CYLINDER:
Check with platform unfolded and up at bed height.

CONNECTING STOP / TAIL / TURN LIGHTS

FXD® gates are supplied with LED Stop / Tail / Turn lights as standard. The LED lights are normally shipped loose to avoid damage during shipping and gate installation. 16-4 light cable has been run through each Outer Mast at the factory. The standard LED lights should be mounted and connected as follows:

TOP LIGHTS are for TAIL /TURN – leads on lights

WHITE = ground
BROWN = tail light
GREEN = turn light

BOTTOM LIGHTS are for TAIL / STOP – leads on lights

WHITE = ground
BROWN = tail light
GREEN = stop light

It is recommended that the 16-4 cables supplied and pre-installed in the Outer Masts be connected as follows:

16-4 cable in right-hand (curb side) mast-

RED = stop light
BROWN = tail light
GREEN = RH turn
YELLOW = ground

16-4 cable in left -hand (driver's side) mast-

RED = stop light
BROWN = tail light
YELLOW = LH turn
GREEN = ground

Use butt connectors with heat shrink to connect lights to the 16-4 cables. Install oval lights using grommets supplied. At the opposite end of the 16-4 cables, cut to required length and make connections to the main light harness by re-using the light plugs for the trailer lights that the lift gate has covered, or partially covered, and will not be used. Do NOT cut or splice into main trailer light harness. Attach the re-used plugs to the 16-4 cables using butt connectors with heat shrink. The ground wire in a standard trailer light cable is usually WHITE. On the curb side match the RED, BROWN, and GREEN wires. Then connect the YELLOW on the 16-4 light cable with WHITE on the trailer light harness. On the driver's side, match the RED, BROWN, and YELLOW wires. Then connect the GREEN wire on the 16-4 light cable with the WHITE on the trailer light harness.

PAINTING THE VEHICLE

The adhesion of any paint to any surface depends first and foremost on whether the surface is clean, both physically and chemically. **It is critical that all cylinder rods are protected during the painting process.**

FXD® rail gates are painted with Leyman Extreme Shield® at the factory and must be touched up using the Extreme Shield® kit provided. Follow directions on the label.

Painting

Leyman Extreme Shield® can be top coated with alkyds, epoxies, or urethanes, if it is desired to top coat the entire lift gate.

Basic Steps

1. While the vehicle is located in the shop area, perform all preparation to the surface, to include any grinding, etc.
2. Using dry rags, remove all excess dirt, grease, and hydraulic fluid from all metal surfaces that will be painted. Take special care not to create larger problems by spreading the excess on any related surfaces.
3. Using a wax and grease remover, clean all heavily greased areas of dirt, hydraulic oil or any other substances from all metal surfaces that are to be painted. This will not only help clean the surface, but allow the metal prep steps do their job better.

NOTE: Remember that using any removers and metal prep, paint, etc. can be dangerous. Be sure that all directions are followed carefully when using these products.

Metal Preparation:

Using the correct equipment, start the metal preparation operation on the surfaces to be painted.

1. Use a metal preparation brush saturated and diluted with “granodine” to scrub all the areas. Follow all safety requirements listed on the material being used.
2. Rinse the surface clean. An unbroken sheet with all the foam rinsed off will indicate a surface is properly prepared and ready for the “galvaprep” application. The surface does not need to be dry to apply the “galvaprep”.
3. Metal preparation material reduction is 3 to 1. Apply to surface from the bottom to the top, before the roof. Remember to keep the surface wet.
4. Using the applicator, apply the “galvaprep” to the desired surfaces (reduction is 3 to 1), starting from the bottom, to the top and over the roof. Rinse at room temperature with fresh water.

NOTE: Follow any and all safety requirements as listed on the material being used.

5. Using a clean air supply, blow dry all seams, joints and crevices. Wipe dry any moisture splatters that appear and clean with dry rags.
6. After processing and drying thoroughly, the surface is ready to be painted.

Mask and protect all surfaces not being painted. Remember to read and follow all safety requirements for materials that you use.

INSTALLATION OF WARNING SIGNS / DECALS

STREET SIDE DECALS

**Warning Signs and Decals will be replaced at any time
FREE OF CHARGE**

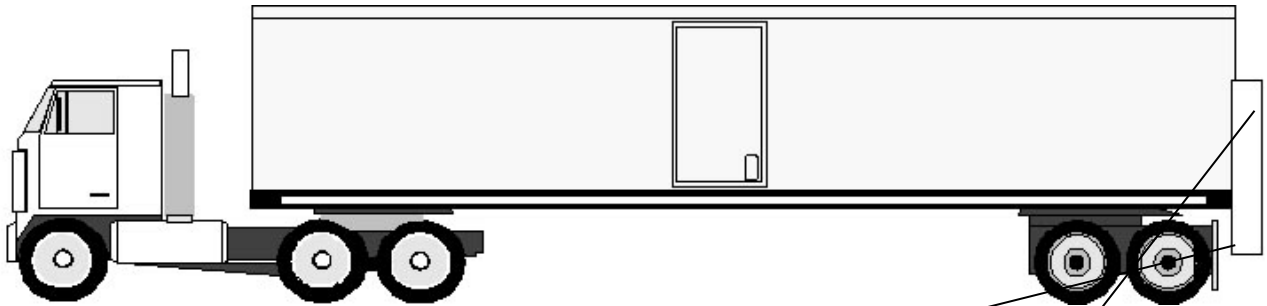

Will receive two of these decals. One goes on each side at bottom of Outer Mast

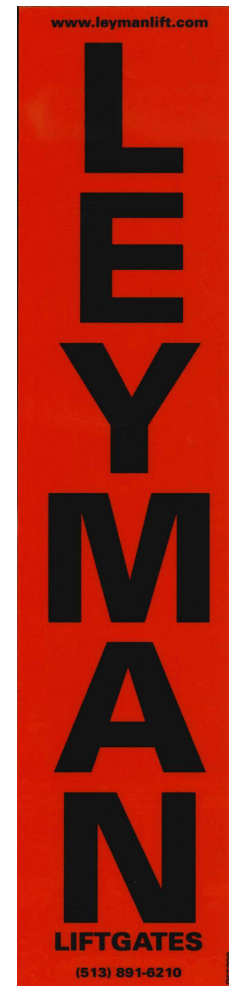

INSTALLATION OF WARNING SIGNS / DECALS

CURB SIDE DECALS

Warning Signs and Decals will be replaced at any time
FREE OF CHARGE

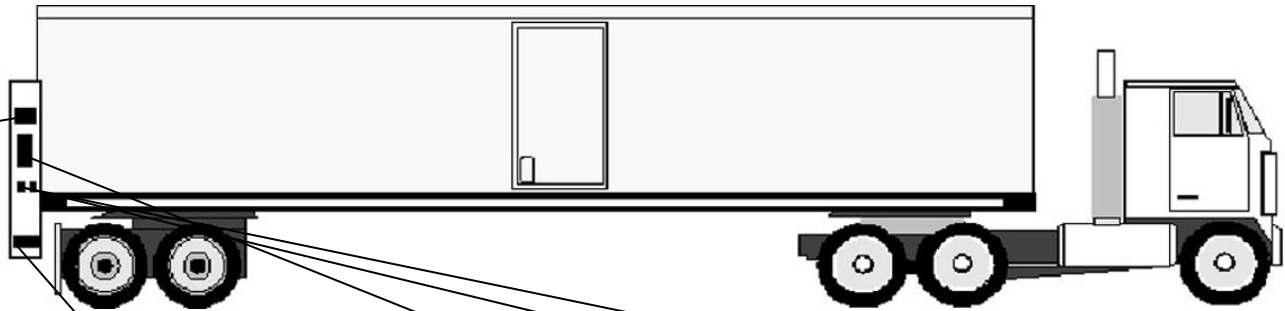

CAUTION

DO NOT STAND BEHIND VEHICLE WHEN OPENING AND OPERATING! USE SAFETY CART STOP.

LEYMAN MANUFACTURING CORP. CINCINNATI OHIO P55205

THE SURFACE TO WHICH THIS LABEL IS TO BE APPLIED MUST BE FREE FROM OIL, GREASE, AND OTHER CONTAMINATES.
Read all 6800 lbs. warning labeling. Apply with firm finger pressure.
COPYRIGHT 1998, BY A LEYMAN GATE.
If this label does not stick to the surface, it's clear the way has been exceeded, therefore do not use.

**URGENT WARNING
ELEVATING GATE INSTRUCTIONS**

- Before Operating Lift, Be Sure You Understand
- Improper operation of this lift can result in serious personal injury. Do not operate unless you have been properly instructed and have read, and are familiar with, the operating instructions. If you do not have a copy of the instructions please obtain them from your employer, distributor, or lessor, as appropriate, before you attempt to operate the lift.
 - Be certain the vehicle is properly and securely braked before using the lift.
 - Always inspect this lift for maintenance or damage before using it. If there are signs of improper maintenance, damage to vital parts, or slippery platform surface, do not use the lift. Do not attempt your own repairs, unless you are specifically trained.
 - Do not overload. See the Mfg. Literature and/or Rating Label on the unit for the rated load. Remember that this limit applies to both raising and lowering operations.
 - Each load should be placed in a stable position as near as possible to the center of the platform.
 - Never stand in or move through or allow anyone else to stand in or move through the area in which the lift may operate or into which an upset load might fall.

P55157

OPERATING INSTRUCTIONS

CAUTION

BEFORE OPERATING THE LIFT, READ AND UNDERSTAND THIS DECAL, URGENT WARNING DECAL AND OWNER'S MANUAL.

DO NOT STAND BEHIND LIFT GATE WHILE UNFOLDING OR USING PLATFORM.

- TO UNFOLD PLATFORM FROM OVER-THE-ROAD POSITION**
- MOMENTARILY FOLD GATE. PUSH THE FOLD AND UP SWITCHES AT THE SAME TIME, AS TO ENSURE GATE IS FULLY FOLDED.
 - TO RELIEVE TENSION ON AUTO LOCK, PUSH THE UP SWITCH (GATE WILL GO UP), PULL HANDLE TO RELEASE AUTO LOCK.
 - LOWER PLATFORM BY PUSHING DOWN SWITCH SO EARS ARE BELOW THE SAFETY PLATE ON OUTER MAST.
 - PUSH THE UNFOLD SWITCH, GATE WILL UNFOLD.

TO DOCK LOAD

- TO RELIEVE TENSION ON AUTO LOCK, PUSH THE UP SWITCH (GATE WILL GO UP), PULL HANDLE TO RELEASE AUTO LOCK.
- LOWER GATE UNTIL EARS ON PLATFORM REST ON STOPS OF OUTER MAST.

TO LOWER PLATFORM, USE DOWN SWITCH ONLY.

TO RAISE PLATFORM, USE UP SWITCH ONLY.

SAFE LOADING OF PLATFORM

- CART STOP OR RETENTION RAMP MUST BE IN PLACE WHENEVER LIFTING OR LOWERING A LOAD. ALSO SEE URGENT WARNING DECAL.

TO FOLD PLATFORM

- RAISE PLATFORM OFF GROUND SO EARS ARE ABOVE THE SAFETY PLATE ON OUTER MAST WHEN PLATFORM FOLDS.
- PUSH THE FOLD AND UP SWITCH AT THE SAME TIME BY USING BOTH HANDS. PLATFORM WILL FOLD. CONTINUE TO RAISE PLATFORM TO THE FULL UP POSITION, AUTO LOCK WILL LATCH.

LEYMAN MANUFACTURING CORPORATION
CINCINNATI, OH 45240
PHONE: (513) 881-4610 P55214

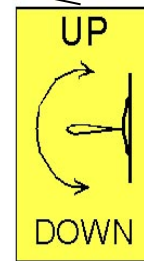
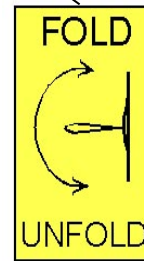

Mount each decal next to the corresponding toggle switch. Make sure you mount three UP / DOWN decals (two on the inside of the Outer Mast). Mount two FOLD / UNFOLD decals (next to the dual switch plate).

**6800 lb.
MAXIMUM
CAPACITY**

P55432

Mount one Max. Cap. decal on outside of Outer Mast near switches. Mount other Max. Cap. decal on Inner Mast just above chain anchor.

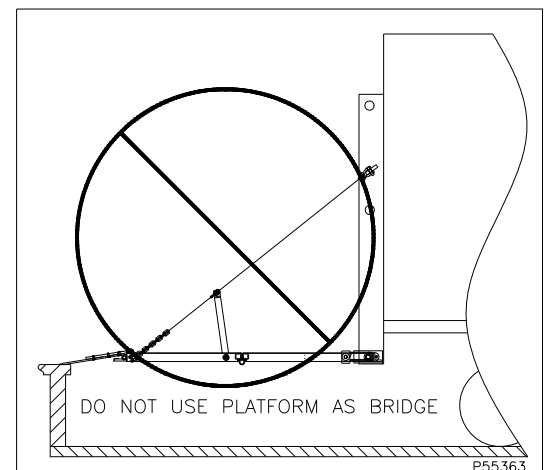

P55363

INSTALLATION OF WARNING SIGNS / DECALS

REAR OF VEHICLE DECALS

**Warning Signs and Decals will be replaced at any time
FREE OF CHARGE**

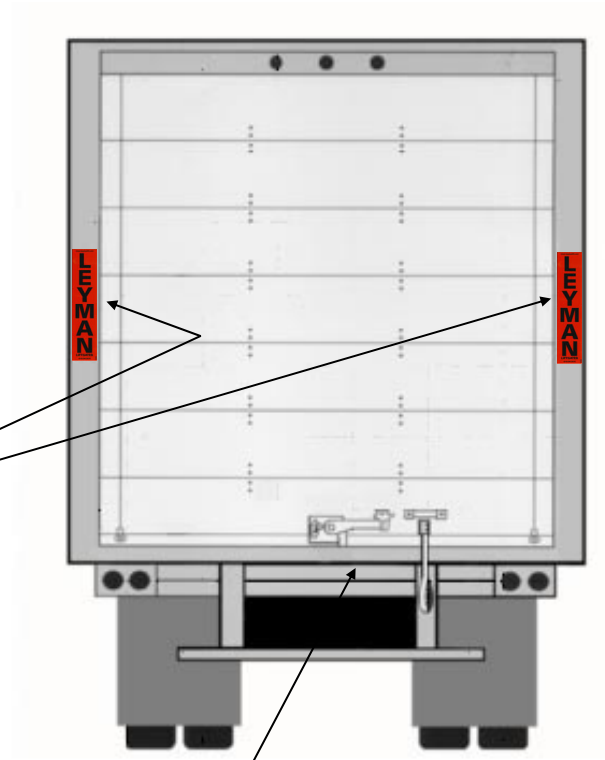

Will receive two of these decals
One goes on the INSIDE of each inner mast
Above the folded platform assembly near top roller



MODEL AND SERIAL NUMBER TAGS

Serial No. is also located in MENU 1 of Maintenance Minder 2®

Serial number tag is located inside power unit box.

| | |
|---|------------------|
|  | |
| 10900 KENWOOD ROAD CINCINNATI, OHIO 45242 513-891-6210 WWW.LEYMANLIFT.COM | |
| MODEL | FXD68DEDA-8684RR |
| SERIAL NO. | 289999 |
| CAPACITY | 6800 lbs. |
| MANUFACTURE DATE | 08-14-08 |

Model number tag is located on the left-hand Outer Mast.

| | |
|---|------------------|
|  | |
| 10900 KENWOOD ROAD CINCINNATI, OHIO 45242 513-891-6210 WWW.LEYMANLIFT.COM | |
| MODEL | FXD68DEDA-8684RR |
| CAPACITY | 6800 lbs. |
| MANUFACTURE DATE | 08-14-08 |
| PATENTS PENDING | |

FINAL INSTALLATION INSPECTION

| | | |
|------------------|--------------------------|---------------------------|
| CUSTOMER: | | |
| LOCATION: | UNIT # / VIN # | |
| VEHICLE#: | LIFT GATE MODEL#: | LIFT GATE SERIAL#: |

√=OK(INITIAL)

N = NOT APPLICABLE

| WELDING | |
|------------------------------|---|
| | Gate is welded secure to vehicle (2" long welds spaced 10" to 12" inside and outside both Outer Masts) at stainless steel mounting channels. |
| | Power pack box is welded to cross members using full length welds. If power pack is securely bolted instead, then ground cable is installed. |
| | Header Kit (dock seal) is securely riveted to vehicle. |
| ELECTRICS | |
| | Check that battery holds downs are tightened securely, and rubber pads are installed under batteries. |
| | Check battery (ies) for proper charge level. PROPER CHARGE LEVEL: |
| | Check all wiring connections for tightness (batteries, switch cable, etc.) |
| | Inspect and check all circuit breakers |
| | Charge line/power line (through cross members with rubber grommets or clamped using loom clamps). |
| | Electric line from gate to power pack (through cross members with rubber grommets or clamped using loom clamps). |
| | Check operation of inside and outside toggle switches. |
| | Check operation of lights in Outer Mast |
| HYDRAULIC | |
| | Hydraulic lines from gate to power pack (through cross members with rubber grommets or clamped using loom clamps). |
| | Hydraulic lines from gate to power pack – check for leaks by running each function at by-pass. |
| | Check reservoir for correct amount of fluid (platform should be open & down when checking) (up if power down).4" below top of tank. |
| | Bleed air from folding cylinder. |
| | Bleed air from lifting cylinders. |
| | Check fold and lift cylinders for leaks |
| | Dual Power Unit – Check operation of both power units. Also test Emergency Pushbutton unit. Then set to operate on primary unit (Selector Switch toggled left). |
| OPERATION OF GATE | |
| | Open and close lift gate. Observe for correct operation (use both power units, plus Emergency Control). |
| | Raise and lower lift gate. Observe for correct operation (use both power units, plus Emergency Control) |
| MISCELANEOUS | |
| | Rear Impact Guard extension installed to meet 12" dimension to primary gate structure. Add reflective tape |
| PAINTING AND SAFETY STICKERS | |
| | Repaint where needed |
| | Check hydraulic cylinder rods for over spray |
| | Install all safety and operation stickers |

SERVICED BY: _____

DATE: _____

4/07

OPERATING THE LIFT GATE

Before operating the lift, read and understand this decal, Urgent Warning decal and Owner's manual.

Do not stand behind lift gate while unfolding or using platform.

To unfold the platform from over-the-road position

1. Toggle the DOWN switch to lower platform.
2. Lower the platform until arrow indicates FOLD / UNFOLD region. Toggle both UNFOLD switches. Gate will unfold.

To dock load

1. Toggle the DOWN switch to lower platform.
2. Continue lowering until platform rests on dock level stops.

WARNING! Never use the platform as a “bridge” to a dock or other vehicle. Platform can fold unexpectedly and cause injury.

To lower platform, use the down switch only.

To raise platform, use the up switch only.

Safe loading of platform

1. Cart stop or retention ramp must be in place whenever lifting or lowering a load. Also, see the Urgent Warning decal.

To fold platform

1. Raise the platform until arrow indicates FOLD / UNFOLD region. Then toggle both FOLD switches until platform completely folds. Raise platform until gate hits Up Stops and arrow indicates locked position. Do not move vehicle unless gate is in locked position.

ELECTRICAL DIAGRAM

BEFORE NOVEMBER 2016

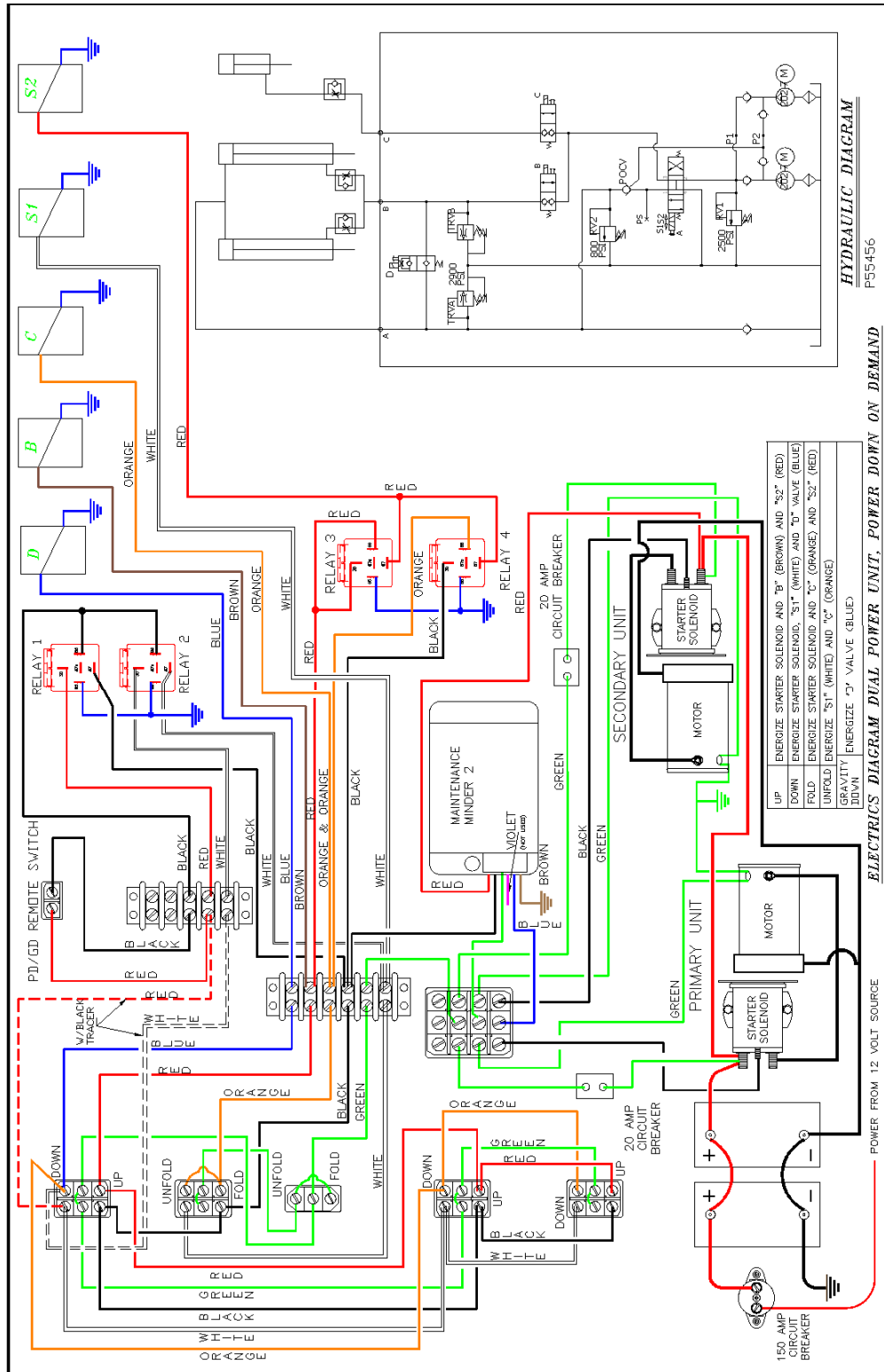

AFTER NOVEMBER 2016

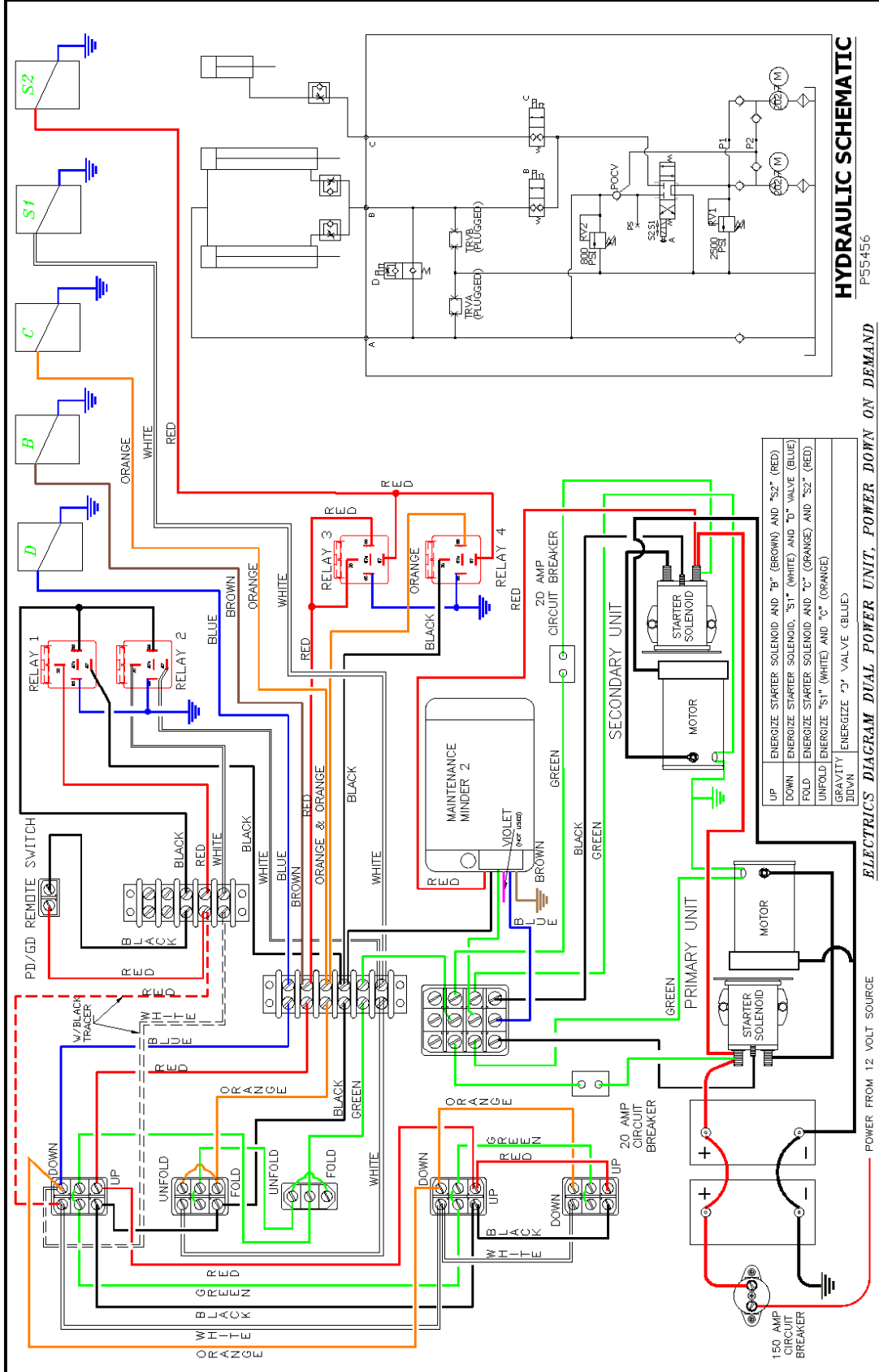

WALK AROUND ELECTRICS

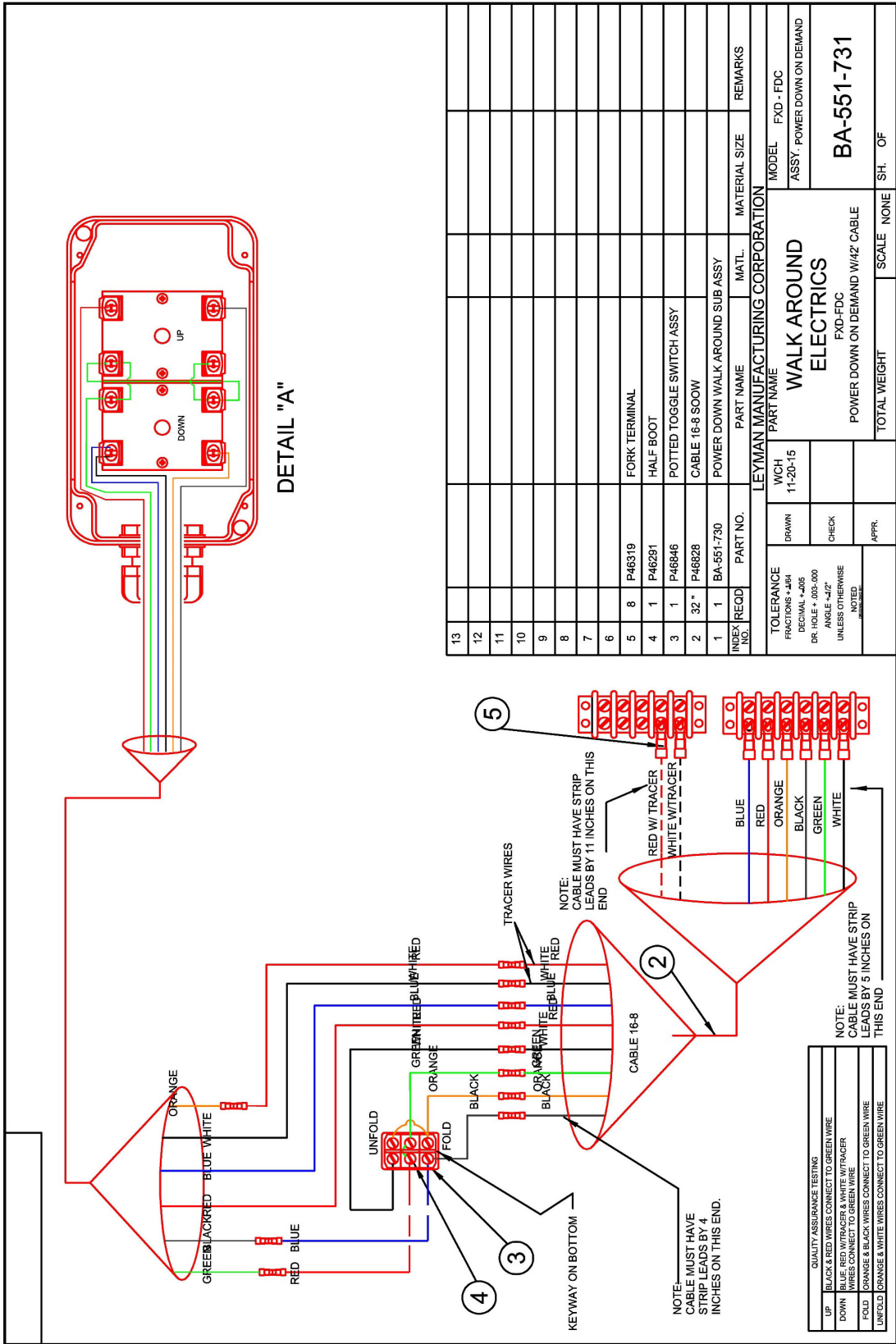

MAINTENANCE MINDER 2[®] OVERVIEW

Power unit is equipped with the Maintenance Minder 2[®] Controller. It will:

- Automatically keep track of maintenance intervals and warn the user when maintenance is due, based on the number of lifts.
- Record low voltage occurrences.
- Record of high temperature faults.
- Record of maximum run time faults, when a single operation exceeded the maximum continuous run time limit.
- Give helpful trouble-shooting information on MENU 4, “Last Lift Info”.

FAULTS CODES

A decal in the power unit enclosure lists the following signal codes for these faults:

| | |
|---------|--|
| 1 BEEP | Service Fault (reached the number of lifts when maintenance is due) |
| 2 BEEPS | Low Voltage Fault (check battery condition and power line connections) |
| 3 BEEPS | Max. Time Fault (exceeded the maximum continuous run time allowed) |
| 4 BEEPS | High Temperature Fault (unit will not run until motor cools) |

All fault signals will be repeated FOUR times, except the Service Fault signal. Controller will prevent power unit from operating during the time period when a fault signal is sounding (about 5 to 10 sec.) except for the Service Fault signal. The controller is also equipped with an anti-doorbelling feature, which prevents rapid ON/OFF operation of the power unit.

RESETTING after MAINTENANCE IS PERFORMED

To RESET the Maintenance Minder 2[®] after maintenance has been performed:

1. Go to MENU 2, hit “ENTER”, and toggle down to the “Reset All Info” screen.
2. Press and hold the hidden RESET button under Maintenance Minder 2[®] logo at top of faceplate.
3. Follow the instructions on the screen regarding a second button, which must be pressed to complete the reset operation.



MAINTENANCE MINDER 2[®] CONTROLLER

MENUS

(Press MENU)

MENU 1 – LIFT GATE INFO

(Press ENTER, then ARROW DOWN for each item)

Model Number, Serial Number, Manufacture Date, Vehicle ID, Hardware Version, Firmware Version, Software Version.



(Press MENU and ARROW DOWN once)

MENU 2 – PERIOD INFO (data for current maintenance period)

(Press ENTER, then ARROW DOWN for each item)

Number of Lifts (gives the number during this maintenance interval and the set number when maintenance is due)

Motor ON (total motor run time in minutes for this maintenance period)

Service Fault (number of times gate was operated PAST the maintenance limit)

Max. Time Faults (times motor exceeded its maximum allowable continuous run time)

High Temperature Faults (times thermal switch in motor tripped, if switch provided)

Low Voltage Faults (times low voltage occurred)

Reset all Info (Reset data after performing maintenance, once maintenance limit is reached – see reset instructions on previous page)



MAINTENANCE MINDER 2[®] CONTROLLER

MENUS

(Press **MENU** and **ARROW DOWN** twice)
MENU 3 – LIFE TIME INFO (data for the total life time of the gate)

(Press **ENTER**, then **ARROW DOWN** for each item)

Same items will appear as under PERIOD INFO, except this is LIFE TIME data.

Reset History (reviews history for each maintenance interval)

Press **ENTER**, then **ARROW DOWN** to show history. Most recent period is the highest #. Screen shows Period #, # of Lifts, and Total Run Time in minutes.



(Press **MENU** and **ARROW DOWN** three times)

MENU 4 – LAST LIFT INFO (Trouble Shooting Screen – it records data that occurred during the last lift made)

(Press **ENTER**, then **ARROW DOWN** for each item)

Supply Voltage (first voltage is the minimum voltage that occurred during the last lift – if below 6 volts gate will stop / second voltage is the supply voltage just before gate operation, must be at least 10 volts).

Motor ON (motor run time in seconds during last lift, gate will stop at 180 seconds).

Window Time (time in milliseconds during the last lift that the voltage dropped in between 6 and 8 volts – must not be any longer than 3 seconds or gate will stop).



NOTE:

Controller has an anti-doorbelling feature. Motor will not operate if UP switch is toggled rapidly. This prevents welding of the start solenoid contacts.

